



The Most Exceptional Commercial Refrigeration Solutions

INNOVATION
LOGISTICS
DISTRIBUTION
LEASING
SERVICE
REFURBISHING
RECYCLING

50 Years of Excellence and Experience



Everything Excellence does is focused on one goal: helping our partners grow their businesses. We produce an extensive range of coolers and freezers for display and storage. Excellence Industries has proven success developing custom solutions for the food, beverage, spirits, and food service industries. We are the premier commercial refrigeration partner for brands such as Nestlé, Pepsi, Ben & Jerry's, Healthy Choice, Remy Martin, Godiva, Outback Steakhouse, Singleton Seafood, Whole Foods, and Marriott.

The Cycle of Excellence

How the continuum of partnership helps your business grow.



Excellence Industries innovates new products and develops custom equipment programs for some of the most successful brands in the food industry. Graphics that break through the clutter at point-of-sale. Staging of deliveries that get units to market when you need them. Lease programs that optimize cash flow for your business. National service contracts that make your refrigeration units completely hassle-free. A proprietary decommissioning process that utilizes the most advanced green technology and exceeds EPA standards.

INNOVATION

The Excellence track record of innovation includes new energy efficient technologies, new ecologically improved refrigerants, breakthrough LED lighting solutions, unique case development and customized accessories.

LOGISTICS

Excellence Industries will automate, report, and set up your logistics to optimize efficiency and maximize your profitability.

DISTRIBUTION

Our network allows Excellence to get your solutions in the field more quickly and more cost efficiently.

The Most Resourceful Innovation in Food Service Refrigeration

The most important thing food service companies hear from Excellence Industries is, "yes." Yes, we can build that one-of-a-kind unit for your newest concept. Yes, we can get units to you quickly. Yes, we have the industry's premier recycling program and take full legal responsibility for decommissioning your equipment in full compliance with EPA regulations. Many food service companies have discovered the power of yes and switched to Excellence. Don't get out-yessed by your competitors. Call Excellence today and speak with a partner.



LEASING

Purchasing refrigerators should never freeze your cash flow. Excellence Industries partners our custom refrigeration solutions with custom financial solutions.

SERVICE

We will customize a service program that meets your needs and keeps your refrigerators and freezers generating business. Excellence has a network of field technicians with years of experience.

REFURBISHING

Refurbish to revive and extend the life of your ice cream bunkers, upright freezers, countertop coolers and more. Fashioned after the Excellence Environmental Company (EECO) recycling program, the refurbishing program is a cost-effective and time-efficient process to extend the life of your equipment.

RECYCLIING

At Excellence, sustainability is more than a marketing term or part of some distant vision statement. Our complete green decommissioning program is a 3-step practice that meets and exceeds EPA standards.

What Does Excellence Industries' Power of Partnership Mean for Your Business?

Your experience is seamless and efficient. It begins with innovative custom designs and graphics. Then Excellence Industries offers logistics and distribution, leasing, service, and recycling—all from one reliable resource.



We become immersed in your business and integrated with your operations. Excellence has five decades of proven success as a superior outsourced solution for all commercial refrigeration needs. Our network spans four continents utilizing factories with production capabilities that exceed one million units annually. For over 50 years, the company has been supplying self-contained refrigeration units that help grow revenue. Excellence Industries produces an extensive range of coolers and freezers for display and storage.





Excellence
Industries

Profit from the Power of Partnership.

Spec Sheets

Index

AC-2	9
AC-6	11
CTF	13
CTFMS	15
EMM	17
EMMHC	19
FT	21
GDF	23
GDR	25
HB	27
HBD	29
HBG	31
HL	33
HM	35
HR	37
ISL	39
MB	41
MC	43
MCSC	45
MCT	47
PGC	49
RF	51
SC	53
SM	55
SPOT	57
UCS	59
VB	61
VCN	63
Notes	65
Warranty	67



AC-2

Air Curtain Display Cooler

500 S. Falkenburg Road
Suite 200 | Tampa, FL 33619
800.441.4014 | 813.870.0340
www.excellenceindustries.com

The company reserves the right to change the design and/or specifications of these products without notice. Printed in the USA.
Current version 8.19

KEY ASPECTS

SPECIAL FEATURES:

- GFCI power cord
- Electronic thermostat
- Energy efficient
- Adjustable shelf
- Innovation in small footprint open cooler technology
- High impulse beverage refrigeration

OPTIONS:

- Graphics
- Casters with 2 locking

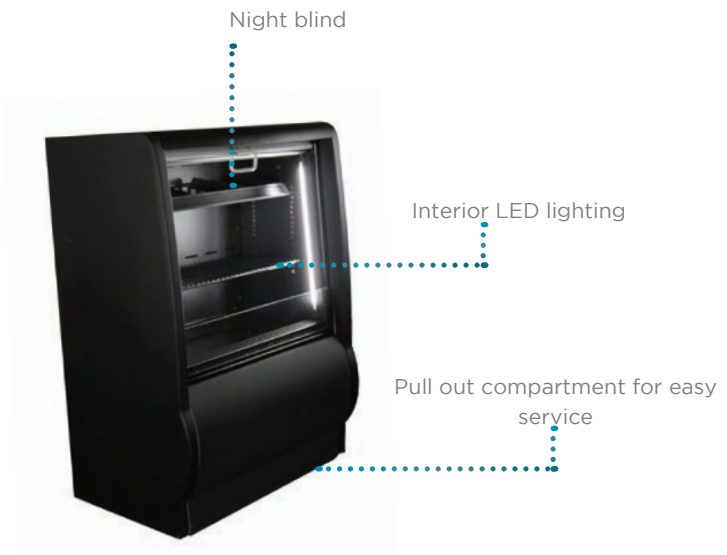

Complies with 2017 DOE standards for commercial cooler without door

TECHNICAL SUMMARY

MODEL	SIZE				ELECTRICAL	REFRIGERATION			OTHER				
	Dimensions (inches)* Width x Depth x Height	Cubic Feet	Net Weight (lbs.)	Shipping Weight (lbs.)**	Voltage/Hz/Phase	Running Amps	Compressor HP	Refrigerant	Temperature	No. of 8.4 oz cans	No. of 12 oz cans	No. of 16.9 oz bottles	Container Quantity
AC-2	25 7/8 x 16 5/8 x 36	2.4	101	116	115/60/1	2.7	1/4	R-134a	+32°F to +41°F	89	54	40	138

*Dimensions are all nominal lengths

**Does not include weight of pallet when needed

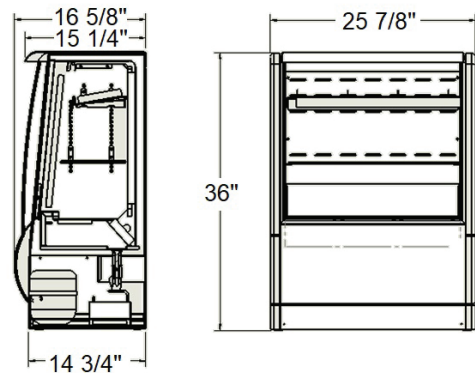

500 S. Falkenburg Road
 Suite 200 | Tampa, FL 33619
 800.441.4014 | 813.870.0340
 www.excellenceindustries.com
 ver. 8.19



AC

Air Curtain Display Cooler

500 S. Falkenburg Road
Suite 200 | Tampa, FL 33619
800.441.4014 | 813.870.0340
www.excellenceindustries.com

The company reserves the right to change the design and/or specifications of these products without notice. Printed in the USA.
Current version 8.19

KEY ASPECTS

SPECIAL FEATURES:

- Easy maintenance and service
- Electronic thermostat
- Energy efficient
- Environmentally friendly hydrocarbon refrigerant
- Price tag molding

OPTIONS:

- Extra shelves
- Graphics
- Casters with 2 locking

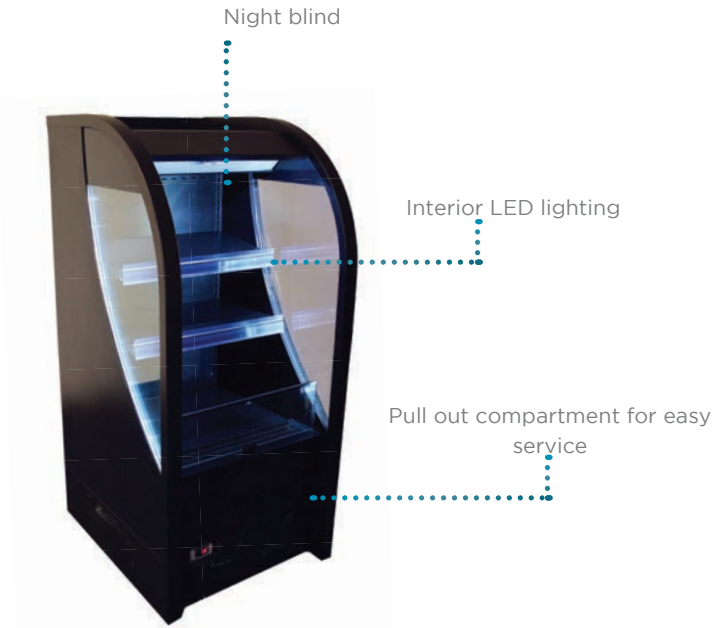

Complies with 2017 DOE standards for commercial cooler without door

TECHNICAL SUMMARY

MODEL	SIZE	ELECTRICAL			REFRIGERATION			OTHER		
	Dimensions (inches)* Width x Depth x Height	Cubic Feet	Net Weight (lbs.)	Shipping Weight (lbs.)**	Voltage/Hz/Phase	Running Amps	Compressor HP	Refrigerant	Temperature	Container Quantity
AC-6HC	25 1/2 x 29 3/8 x 57 3/8	6.0	297	364	115/60/1	8.0	1/2	R-290	+32°F to +41°F	42

*Dimensions are all nominal lengths

**Does not include weight of pallet when needed

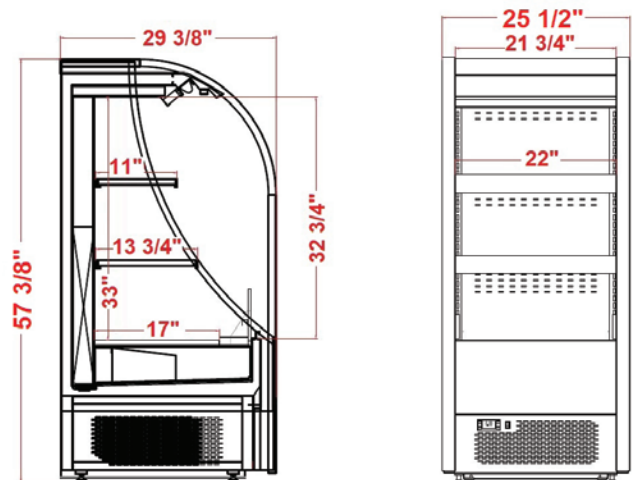

500 S. Falkenburg Road
Suite 200 | Tampa, FL 33619
800.441.4014 | 813.870.0340
www.excellenceindustries.com
ver. 8.19



CTF

Countertop Freezer & Ice Cream Freezer

500 S. Falkenburg Road
Suite 200 | Tampa, FL 33619
800.441.4014 | 813.870.0340
www.excellenceindustries.com

The company reserves the right to change the design and/or specifications of these products without notice. Printed in the USA.
Current version 8.19

KEY ASPECTS

SPECIAL FEATURES:

- 3 adjustable shelves (CTF-3HC)
- 2 adjustable shelves (CTF-2HC)
- Right hinge self closing door
- Environmentally friendly hydrocarbon refrigerant

OPTIONS:

- Lighted door graphic
- Graphics
- Left hinge units



Optional lighted door graphic



Double Combo-MCT-4HC with 2 optional CTF-3HC



Combo MCT-2HC with one optional CTF-3HC



Complies with 2017 DOE standards for commercial freezer and ice cream freezer

TECHNICAL SUMMARY

MODEL	SIZE				ELECTRICAL		REFRIGERATION			OTHER	
	Dimensions (inches)* Width x Depth x Height	Cubic Feet	Net Weight (lbs.)	Shipping Weight (lbs.)**	Voltage/Hz/Phase	Running Amps	Compressor HP	Refrigerant	Temperature	No. of Optional Baskets	Container Quantity
CTF-2HC	22 1/2 x 20 7/8 x 21 3/8	1.9	76	84	115/60/1	2.1	1/4	R-290	-15°F to +15°F	2	304
CTF-3HC	24 x 21 1/8 x 27 1/8	3.4	95	103	115/60/1	3.6	2/5	R-290	-15°F to +15°F	3	171

*Dimensions are all nominal lengths

**Does not include weight of pallets when needed

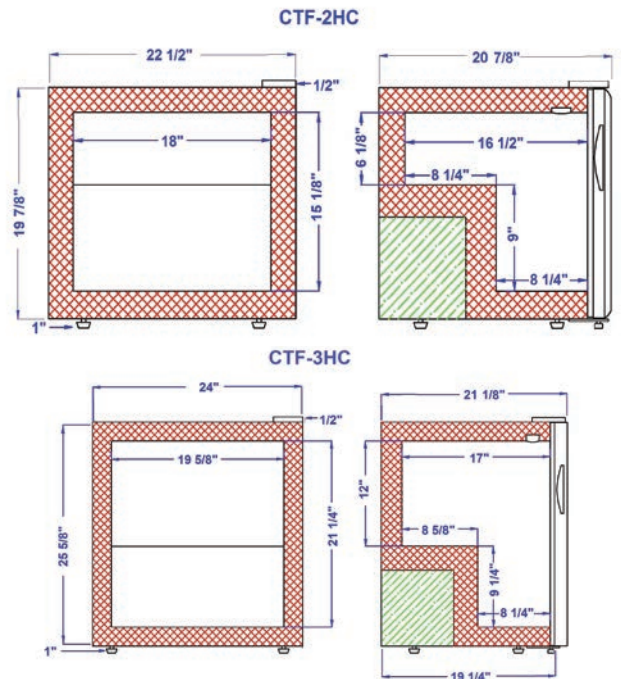

500 S. Falkenburg Road
Suite 200 | Tampa, FL 33619
800.441.4014 | 813.870.0340
www.excellenceindustries.com
ver. 8.19



CTF MS

Countertop Freezer & Ice Cream Freezer
with Merchandising Sign

500 S. Falkenburg Road
Suite 200 | Tampa, FL 33619
800.441.4014 | 813.870.0340
www.excellenceindustries.com

The company reserves the right to change the design and/or specifications of these products without notice. Printed in the USA.
Current version 8.19

KEY ASPECTS

SPECIAL FEATURES:

- Environmentally friendly hydrocarbon refrigerant
- 3 adjustable shelves (CTF-3MSHC)
- 2 adjustable shelves (CTF-2MSHC)
- Fully insulated glass door
- Right hinged self closing door

OPTIONS:

- Light door graphic (minimum quantities apply)
- Graphics

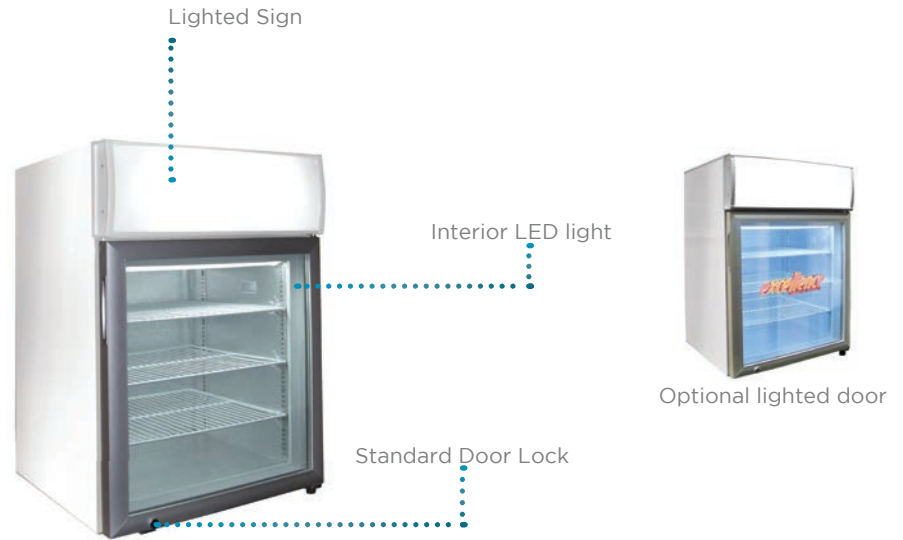

Complies with 2017 DOE standards for commercial freezer and ice cream freezer

TECHNICAL SUMMARY

MODEL	SIZE	ELECTRICAL			REFRIGERATION			OTHER			
	Dimensions (inches)* Width x Depth x Height	Cubic Feet	Net Weight (lbs.)	Shipping Weight (lbs.)**	Voltage/Hz/Phase	Running Amps	Compressor HP	Refrigerant	Temperature	No. of shelves	Container Quantity
CTF-2HCMS	22 5/8 x 21 1/2 x 26 1/4	1.9	90	96	115/60/1	2.1	1/4	R-290	-15°F to +5°F	2	171
CTF-4HCMS	24 x 21 7/8 x 35 5/8	4.2	110	117	115/60/1	3.6	2/5	R-290	-15°F to +5°F	3	114

*Dimensions are all nominal lengths

**Does not include weight of pallets when needed



CTF-2MSHC

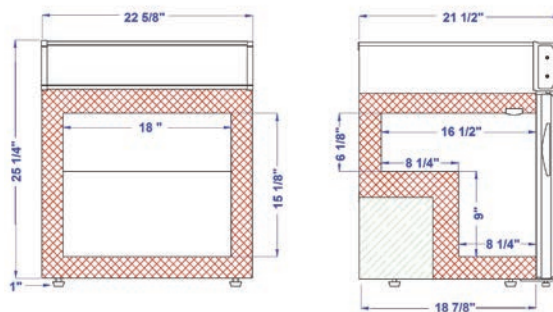

CTF-4MSHC

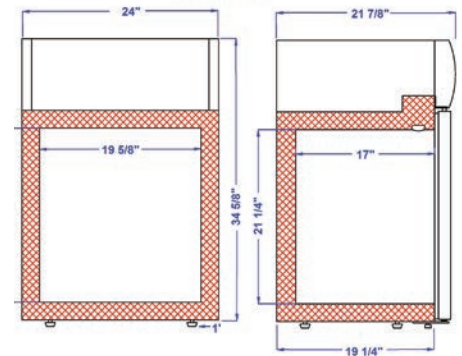

500 S. Falkenburg Road
 Suite 200 | Tampa, FL 33619
 800.441.4014 | 813.870.0340
www.excellenceindustries.com
 ver. 8.19



EMM

Countertop Cooler

500 S. Falkenburg Road
Suite 200 | Tampa, FL 33619
800.441.4014 | 813.870.0340
www.excellenceindustries.com

The company reserves the right to change the design and/or specifications of these products without notice. Printed in the USA.
Current version 8.19

KEY ASPECTS

SPECIAL FEATURES:

- Interior LED light
- Recessed handle
- Adjustable thermostat
- Door lock standard
- Reversible door

OPTIONS:

- Graphics
- Stainless doors for EMM-3S & EMM-4S



TECHNICAL SUMMARY

MODEL	SIZE	ELECTRICAL			REFRIGERATION			OTHER			
	Dimensions (inches)* Width x Depth x Height	Cubic Feet	Net Weight (lbs.)	Shipping Weight (lbs.)**	Voltage/Hz/Phase	Running Amps	Compressor HP	Refrigerant	Temperature	No. of Shelves	Container Quantity
EMM-2S	17 1/8 x 19 3/4 x 20*	1.8	40	44	115/60/1	0.7	1/10	R-134a	+32°F to +40°F	2	352
EMM-3S	17 1/8 x 19 3/4 x 27 1/4*	2.5	49	54	115/60/1	0.7	1/10	R-134a	+32°F to +40°F	3	264
EMM-4S	19 x 18 3/4 x 33 1/2*	3.8	64	68	115/60/1	0.8	1/10	R-134a	+32°F to +40°F	3	252

*Dimensions are all nominal lengths

**Does not include weight of pallets when needed



500 S. Falkenburg Road
 Suite 200 | Tampa, FL 33619
 800.441.4014 | 813.870.0340
www.excellenceindustries.com
 ver. 8.19



EMMHC

Countertop Cooler

500 S. Falkenburg Road
Suite 200 | Tampa, FL 33619
800.441.4014 | 813.870.0340
www.excellenceindustries.com

The company reserves the right to change the design and/or specifications of these products without notice. Printed in the USA.
Current version 8.19

KEY ASPECTS

SPECIAL FEATURES:

- Interior LED light
- Environmentally friendly hydrocarbon refrigerant
- Recessed handle
- Adjustable thermostat
- Door lock and key

OPTIONS:

- Graphics



Complies with 2017 DOE standards for commercial cooler

TECHNICAL SUMMARY

MODEL	SIZE				ELECTRICAL		REFRIGERATION			OTHER	
	Dimensions (inches)* Width x Depth x Height	Cubic Feet	Net Weight (lbs.)	Shipping Weight (lbs.)**	Voltage/Hz/Phase	Running Amps	Compressor HP	Refrigerant	Temperature	No. of Shelves	Container Quantity
EMM-2HC	17 x 19 3/4 x 20	1.6	44	50	115/60/1	0.9	1/12	R-600a	+32° to +40°F	1	384
EMM-3HC	17 x 19 3/4 x 27 1/4	2.5	55	63	115/60/1	0.9	1/12	R-600a	+32° to +40°F	3	288
EMM-4HC	19 1/2 x 19 3/4 x 33 3/8	3.7	75	81	115/60/1	1.2	1/12	R-600a	+32° to +40°F	4	252
EMM-5HC	21 3/8 x 22 1/4 x 33 3/8	4.3	82	90	115/60/1	1.1	1/12	R-600a	+32° to +40°F	4	171

*Dimensions are all nominal lengths

**Does not include weight of pallets when needed



500 S. Falkenburg Road
Suite 200 | Tampa, FL 33619
800.441.4014 | 813.870.0340
www.excellenceindustries.com
ver. 8.19

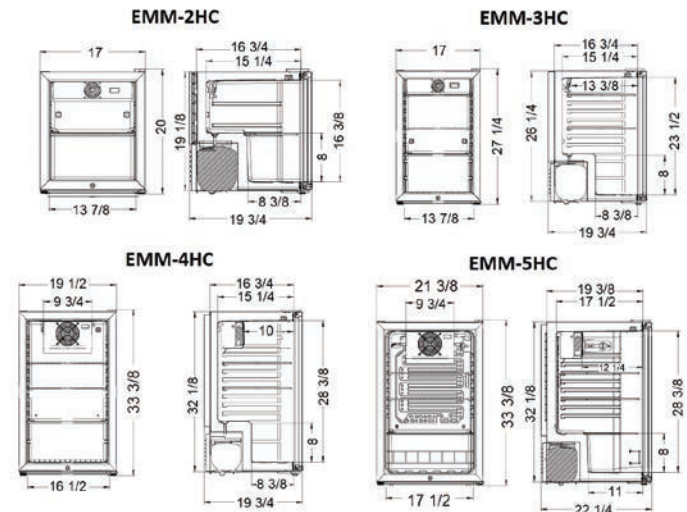



FT

Ice Cream Storage Freezer

500 S. Falkenburg Road
Suite 200 | Tampa, FL 33619
800.441.4014 | 813.870.0340
www.excellenceindustries.com

The company reserves the right to change the design and/or specifications of these products without notice. Printed in the USA.
Current version 8.19

KEY ASPECTS

SPECIAL FEATURES:

- Integrated lid stop protectors
- Recessed door handles
- Small footprint
- Holds 4 3-Gallon tubs

OPTIONS:

- Graphics

Stainless steel exterior

Heavy duty metal hinges for flip flop lids



2 locking casters standard



Stainless interior



Complies with 2017 DOE standards for commercial ice cream freezer

TECHNICAL SUMMARY

MODEL	SIZE				ELECTRICAL		REFRIGERATION			OTHER	
	Dimensions (inches)* Width x Depth x Height	Cubic Feet	Net Weight (lbs.)	Shipping Weight (lbs.)**	Voltage/Hz/Phase	Running Amps	Compressor HP	Refrigerant	Temperature	3 Gal. Can Capacity/ Total Facing	Container Quantity
FT-4	25 3/8 x 15 1/2 x 37 3/4	2.8	90	103	115/60/1	1.4	1/8	R-134a	-15°F to +5°F	4/2	170

*Dimensions are all nominal lengths

**Does not include weight of pallet when needed

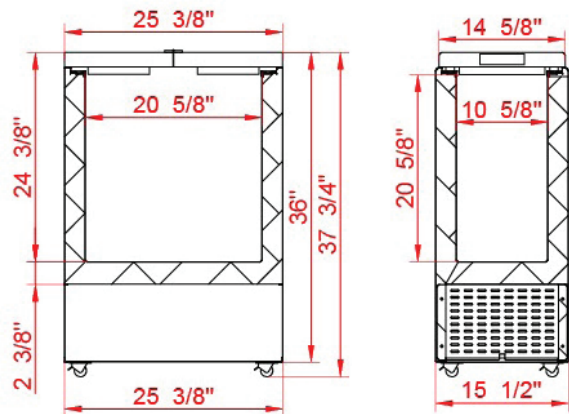

500 S. Falkenburg Road
Suite 200 | Tampa, FL 33619
800.441.4014 | 813.870.0340
www.excellenceindustries.com
ver. 8.19



GDF

Glass Door Freezer

500 S. Falkenburg Road
Suite 200 | Tampa, FL 33619
800.441.4014 | 813.870.0340
www.excellenceindustries.com

The company reserves the right to change the design and/or specifications of these products without notice. Printed in the USA.
Current version 8.19

KEY ASPECTS

SPECIAL FEATURES:

- Illuminated top merchandising sign (GDF-13, 22, 43)
- Digital temperature control with wide range setting
- Stainless steel bottom pan
- Automatic defrost

OPTIONS:

- Graphics
- Lock
- Basket shelves
- Basket shelf dividers



Complies with 2017 DOE standards for commercial freezer and ice cream freezer GDF-43 freezer only

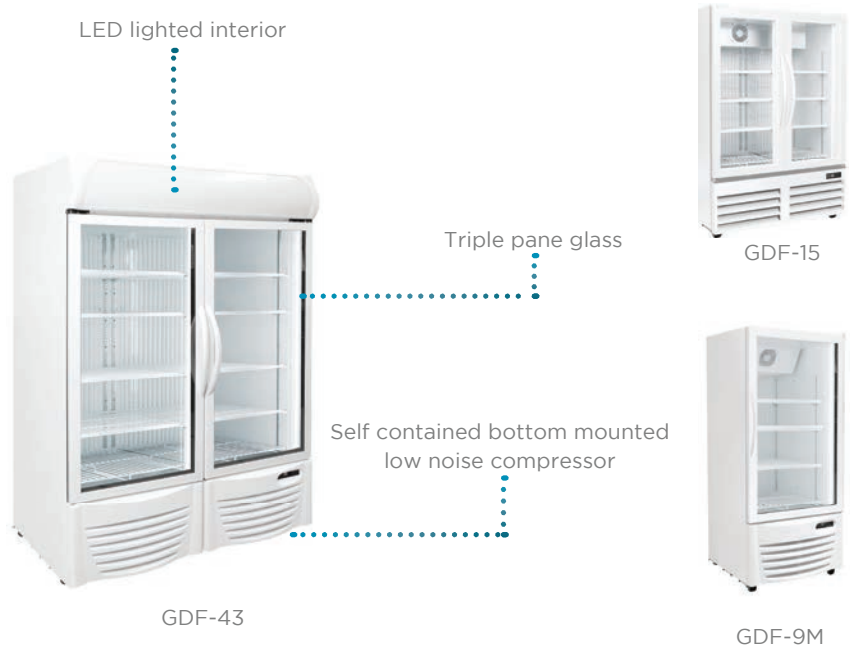

TECHNICAL SUMMARY

MODEL	SIZE Dimensions (inches)* Width x Depth*** x Height	SIZE			ELECTRICAL		REFRIGERATION			OTHER	
		Cubic Feet	Net Weight (lbs.)	Shipping Weight (lbs.)**	Voltage/Hz/Phase	Running Amps	Compressor HP	Refrigerant	Temperature	No. of Optional Baskets	Container Quantity
GDF-9M	23 3/4 x 25 x 54	7.3	210	225	115/60/1	1.8	1/4	R-290	-20°F to +0°F	3	66
GDF-13	26 1/2 x 28 1/2 x 62 1/4	12.0	245	274	115/60/1	4.5	1/2	R-290	-20°F to +0°F	3	54
GDF-15	36 x 28 1/4 x 54	14.1	310	330	115/60/1	5.0	1/2	R-290	-20°F to +0°F	6	30
GDF-22	30 x 34 3/8 x 78 3/4	22.7	340	362	115/60/1	4.6	1/2	R-290	-20°F to +0°F	4	34
GDF-43	46 1/2 x 34 1/8 x 78 3/4	37.1	505	567	115/60/1	7.5	1	R-290	-20°F to +0°F	8	26

*Dimensions are all nominal lengths

**Does not include weight of pallets when needed

***Add 2" depth for handle



500 S. Falkenburg Road
Suite 200 | Tampa, FL 33619
800.441.4014 | 813.870.0340
www.excellenceindustries.com
ver. 8.19

Line drawings available upon request



GDR

Glass Door Cooler

500 S. Falkenburg Road
Suite 200 | Tampa, FL 33619
800.441.4014 | 813.870.0340
www.excellenceindustries.com

The company reserves the right to change the design and/or specifications of these products without notice. Printed in the USA.
Current version 8.19

KEY ASPECTS

SPECIAL FEATURES:

- Forced air refrigeration
- 4 adjustable legs - GDR-10HC & GDR-12HC
- 4 casters - GDR-5HC
- Environmentally friendly hydrocarbon refrigerant
- Lock & key - GDR-5HC

OPTIONS:

- Graphics
- Etched door graphic



Complies with 2017 DOE standards for commercial cooler

TECHNICAL SUMMARY

MODEL	SIZE				ELECTRICAL		REFRIGERATION			OTHER			
	Dimensions (inches)* Width x Depth x Height	Cubic Feet	Net Weight (lbs.)	Shipping Weight (lbs.)**	Voltage/Hz/Phase	Running Amps	Compressor HP	Refrigerant	Temperature	No. of shelves	No. of 12 oz. cans	No. of 20 oz. bottles	Container Quantity
GDR-5HC	20 x 20 1/2 x 50 3/8	5.0	110	119	115/60/1	2.2	1/5	R-600a	+32° to +35°F	3	96	60	152
GDR-10HC	25 x 24 1/4 x 54 1/4	9.0	176	194	115/60/1	3.5	1/2	R-290	+32° to +35°F	4	252	126	72
GDR-12HC	25 x 24 1/4 x 63 5/8	12.0	198	217	115/60/1	3.2	1/2	R-290	+32° to +35°F	5	294	168	72

*Dimensions are all nominal lengths

**Does not include weight of pallets when needed

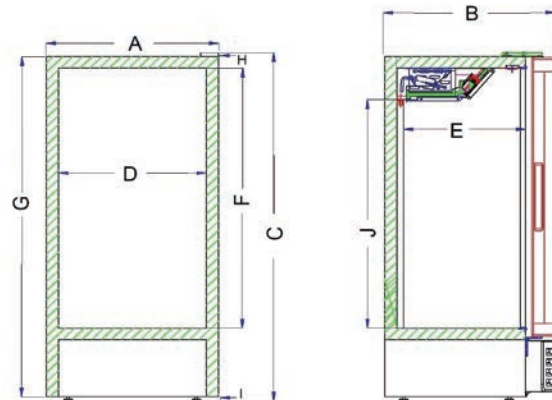

ALL DIMENSIONS IN INCHES										
A	B	C	D	E	F	G	H	I*	J	
20	20 1/2	50 3/8	16 5/8	15 1/4	33	47 3/8	0	3	26 7/8	
25	24 1/4	54 1/4	21 3/8	17 5/8	40 3/8	52 7/8	3/4	5/8	35 3/8	
25	24 1/4	63 5/8	21 3/8	17 5/8	49 3/4	62 1/4	3/4	5/8	44 7/8	

* The GDR-5 has casters. The GDR-10 and GDR-12 have legs

500 S. Falkenburg Road
 Suite 200 | Tampa, FL 33619
 800.441.4014 | 813.870.0340
www.excellenceindustries.com
 ver. 8.19



HB

Dual Temp Cooler and Freezer

500 S. Falkenburg Road
Suite 200 | Tampa, FL 33619
800.441.4014
www.excellenceindustries.com

The company reserves the right to change the design and/or specifications of these products without notice. Printed in the USA.
Current version 01.20

KEY ASPECTS

SPECIAL FEATURES:

- LED interior lighting
- Painted steel interior
- Environmentally friendly hydrocarbon refrigerant
- Casters with 2 locking

OPTIONS:

- Graphics
- Lock and key
- Dipper well
- Hanging baskets with product dividers
- 3-gallon hanging baskets with collar
- Gelato pans and holders
- Sneeze shield



Complies with 2017 DOE standards for commercial cooler and freezer

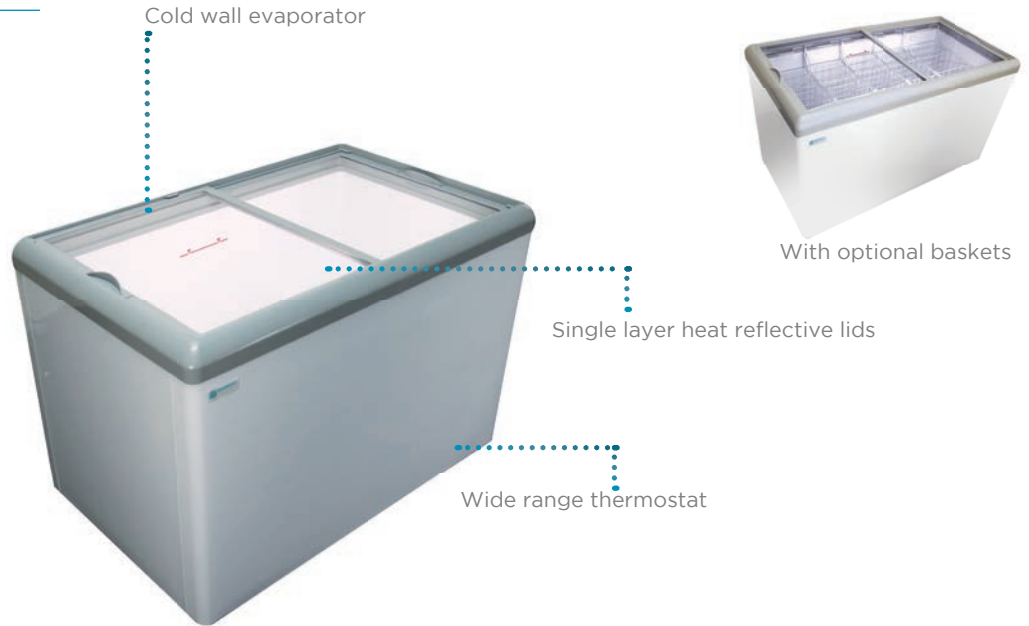

TECHNICAL SUMMARY

MODEL	SIZE Dimensions (inches)* Width x Depth x Height	ELECTRICAL			REFRIGERATION			OTHER			
		Cubic Feet	Net Weight (lbs.)	Shipping Weight (lbs.)**	Voltage/Hz/Phase	Running Amps	Compressor HP	Refrigerant	Temperature	No. of Optional Baskets	Container Quantity
HB-6HCD	28 1/2 x 27 3/8 x 32 5/8	6.4	108	122	115/60/1	1.3	1/7	R-290	-5° to +40°F	2	135
HB-7HCD	31 1/2 x 27 3/8 x 32 5/8	7.4	117	130	115/60/1	1.3	1/7	R-290	-5° to +40°F	3	117
HB-11HCD	43 1/2 x 27 3/8 x 32 5/8	11.1	143	164	115/60/1	1.4	1/5	R-290	-5° to +40°F	4	90
HB-14HCD	51 3/4 x 27 3/8 x 32 5/8	13.8	166	187	115/60/1	2.0	1/4	R-290	-5° to +40°F	5	75
HB-17HCD	59 1/2 x 27 3/8 x 32 5/8	16.5	181	201	115/60/1	2.0	1/4	R-290	-5° to +40°F	6	66
HB-20HCD	70 5/8 x 27 3/8 x 32 5/8	20.0	213	238	115/60/1	4.1	1/2	R-290	-5° to +40°F	7	56

*Dimensions are all nominal lengths

**Does not include weight of pallets when needed

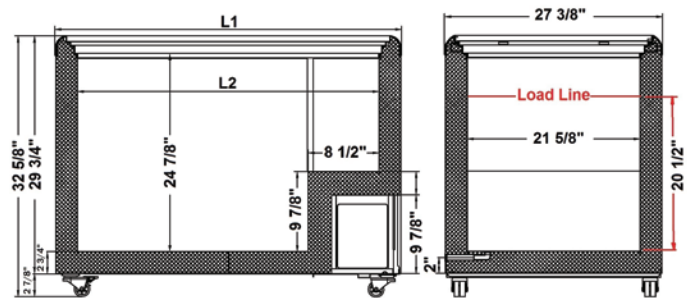

	HB-6HC	HB-7HC	HB-11HC	HB-14HC	HB-17HC	HB-20HC
L1	28 1/2"	31 1/2"	43 1/2"	51 3/4"	59 1/2"	70 5/8"
L2	22 7/8"	25 7/8"	37 7/8"	46"	53 3/4"	65 1/8"

500 S. Falkenburg Road
 Suite 200 | Tampa, FL 33619
 800.441.4014 | 813.870.0340
www.excellenceindustries.com
 ver. 01.20



HBD

Dipping Cabinet

500 S. Falkenburg Road
Suite 200 | Tampa, FL 33619
800.441.4014 | 813.870.0340
www.excellenceindustries.com

The company reserves the right to change the design and/or specifications of these products without notice. Printed in the USA.
Current version 01.20

KEY ASPECTS

SPECIAL FEATURES:

- Painted steel interior
- Casters standard-2 locking
- Extra storage
- Mezzanine shelf
- Environmentally friendly hydrocarbon refrigerant

OPTIONS:

- Lock and key
- Dipper well
- Graphics
- Night covers

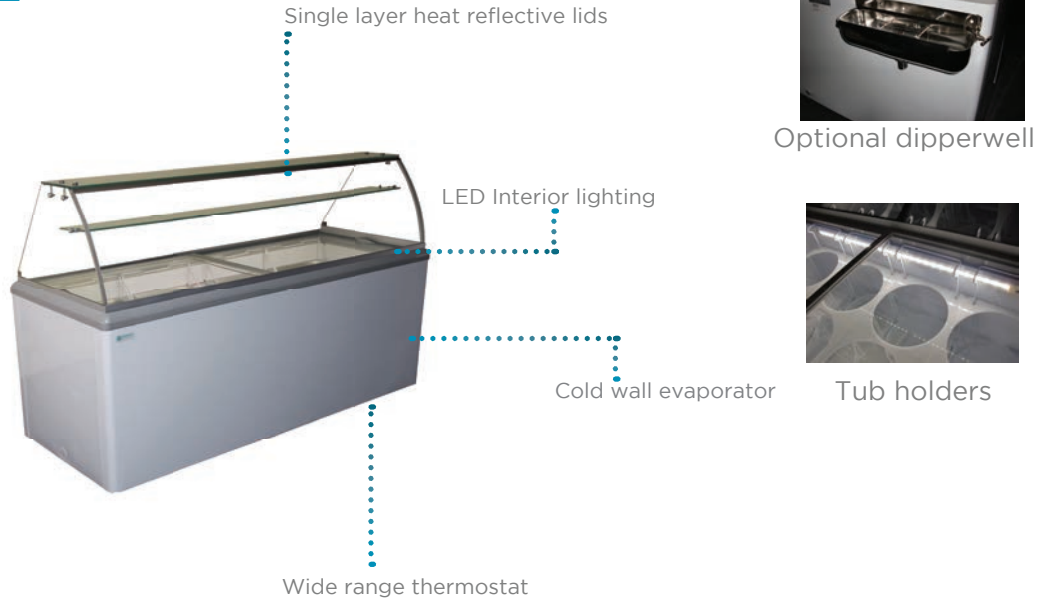

Complies with 2017 DOE standards for commercial service over counter freezer and service over counter ice cream freezer

TECHNICAL SUMMARY

MODEL	SIZE				ELECTRICAL		REFRIGERATION			OTHER		
	Dimensions (inches)* Width x Depth x Height	Cubic Feet	Net Weight (lbs.)	Shipping Weight (lbs.)**	Voltage/Hz/Phase	Running Amps	Compressor HP	Refrigerant	Temperature	3 Gallon cans displayed	3 Gallon cans stored	Container Quantity
HBD-4HC	28 1/2 x 27 3/8 x 50 1/8	6.4	163	188	115/60/1	1.3	1/7	R-290	-15°F to +15°F	4	2	99
HBD-6HC	43 1/2 x 27 3/8 x 50 1/8	11.1	214	253	115/60/1	1.4	1/5	R-290	-15°F to +15°F	6	4	67
HBD-8HC	51 3/4 x 27 3/8 x 50 1/8	13.8	265	292	115/60/1	2.0	1/4	R-290	-15°F to +15°F	8	6	56
HBD-10HC	59 1/2 x 27 3/8 x 50 1/8	16.5	295	320	115/60/1	2.0	1/4	R-290	-15°F to +15°F	10	8	49
HBD-12HC	70 5/8 x 27 3/8 x 50 1/8	20.0	343	376	115/60/1	4.1	1/2	R-290	-15°F to +15°F	12	10	42

*Dimensions are all nominal lengths

**Does not include weight of pallet when needed

Note- Some assembly required

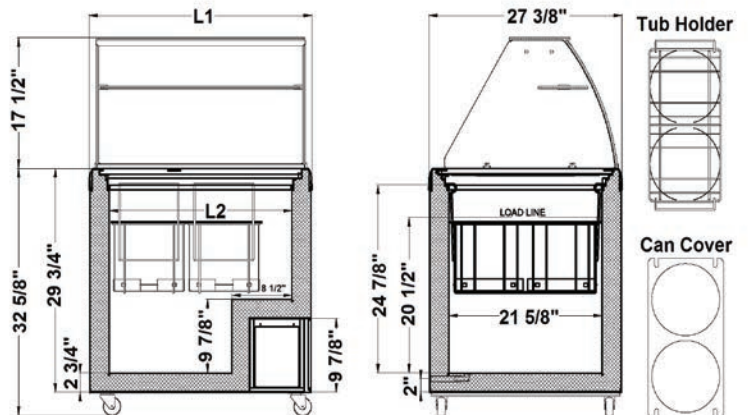

	HBD-4HC	HBD-6HC	HBD-8HC	HBD-10HC	HBD-12HC
L1	28 1/2"	43 1/2"	51 3/4"	59 1/2"	70 5/8"
L2	22 7/8"	37 7/8"	46 1/8"	53 7/8"	65 1/8"



500 S. Falkenburg Road
Suite 200 | Tampa, FL 33619
800.441.4014 | 813.870.0340
www.excellenceindustries.com
ver. 01.20



HBG

Gelato Scooping Cabinet

500 S. Falkenburg Road
Suite 200 | Tampa, FL 33619
800.441.4014 | 813.870.0340
www.excellenceindustries.com

The company reserves the right to change the design and/or specifications of these products without notice. Printed in the USA.
Current version 01.20

KEY ASPECTS

SPECIAL FEATURES:

- Painted steel interior
- Standard with SS pans
- Casters standard-2 locking
- Extra storage
- Mezzanine shelf
- Environmentally friendly hydrocarbon refrigerant

OPTIONS:

- Lock and key
- Dipper well
- Graphics



Complies with 2017 DOE standards for commercial service over counter freezer and service over counter ice cream freezer

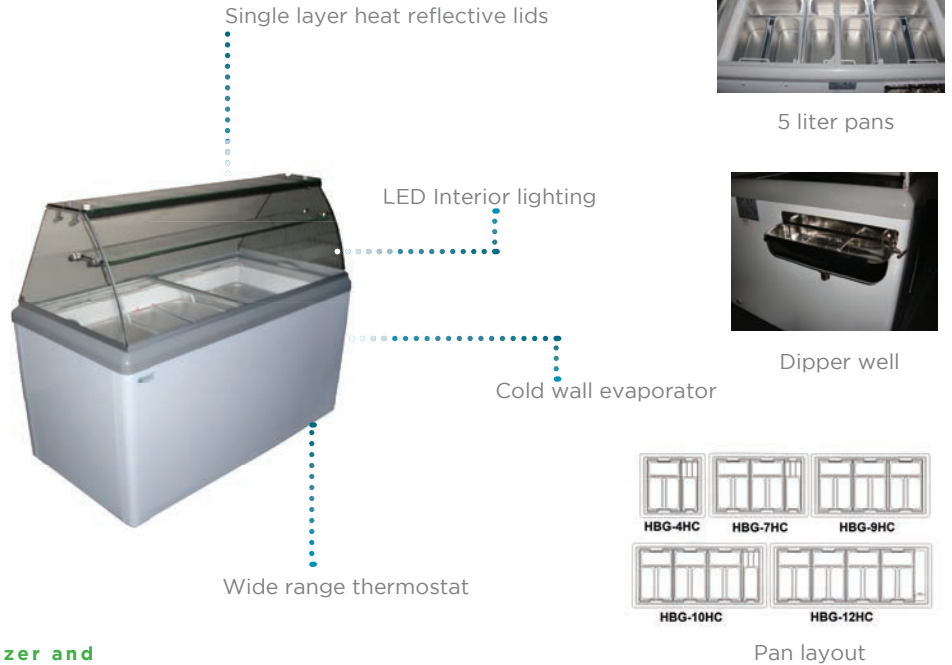

TECHNICAL SUMMARY

MODEL	SIZE	ELECTRICAL			REFRIGERATION			OTHER			
	Dimensions (inches)* Width x Depth x Height	Cubic Feet	Net Weight (lbs.)	Shipping Weight (lbs.)**	Voltage/Hz/Phase	Running Amps	Compressor HP	Refrigerant	Temperature	Gelato pans displayed	Container Quantity
HBG-4HC	28 1/2 x 27 3/8 x 50 1/8	6.4	164	193	115/60/1	1.3	1/7	R-290	-15° to +15°F	4	99
HBG-7HC	43 1/2 x 27 3/8 x 50 1/8	11.1	218	262	115/60/1	1.4	1/5	R-290	-15° to +15°F	7	67
HBG-9HC	51 3/4 x 27 3/8 x 50 1/8	13.8	268	305	115/60/1	2.0	1/4	R-290	-15° to +15°F	9	56
HBG-10HC	59 1/2 x 27 3/8 x 50 1/8	16.5	298	334	115/60/1	2.0	1/4	R-290	-15° to +15°F	10	49
HBG-12HC	70 5/8 x 27 3/8 x 50 1/8	20.0	346	394	115/60/1	4.1	1/2	R-290	-15° to +15°F	12	42

*Dimensions are all nominal lengths

**Does not include weight of pallet when needed

Note- Some assembly required



500 S. Falkenburg Road
Suite 200 | Tampa, FL 33619
800.441.4014 | 813.870.0340
www.excellenceindustries.com
ver. 01.20

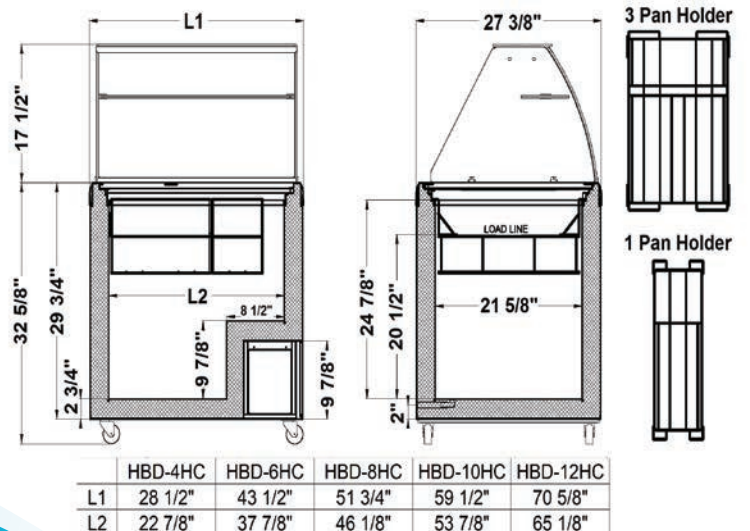



HL

Low Temp Display Freezer and Ice Cream Freezer

500 S. Falkenburg Road
Suite 200 | Tampa, FL 33619
800.441.4014
www.excellenceindustries.com

The company reserves the right to change the design and/or specifications of these products without notice. Printed in the USA.
Current version 01.20

KEY ASPECTS

SPECIAL FEATURES:

- LED interior lighting
- Painted steel interior
- Environmentally friendly hydrocarbon refrigerant
- Casters with 2 locking

OPTIONS:

- Graphics
- Lock and key
- Dipper well
- Hanging baskets with product dividers
- 3-gallon hanging baskets with collar
- Gelato pans and holders
- Sneeze shield



Complies with 2017 DOE standards for commercial freezer and ice cream freezer

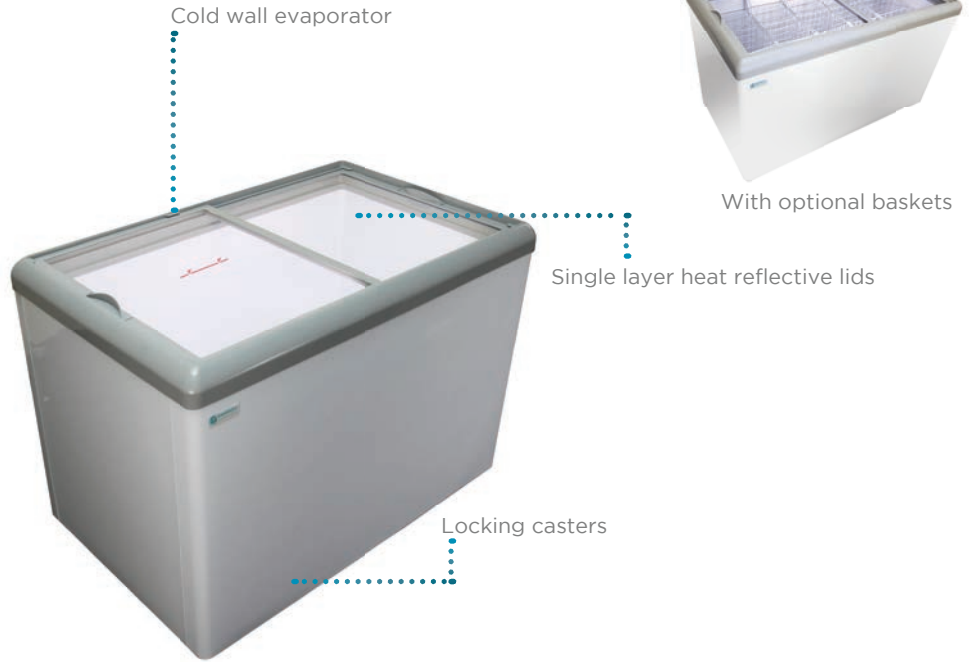

TECHNICAL SUMMARY

MODEL	SIZE Dimensions (inches)* Width x Depth x Height	ELECTRICAL			REFRIGERATION			OTHER			
		Cubic Feet	Net Weight (lbs.)	Shipping Weight (lbs.)**	Voltage/Hz/Phase	Running Amps	Compressor HP	Refrigerant	Temperature	No. of Optional Baskets	Container Quantity
HL-6HC	28 1/2 x 27 3/8 x 32 5/8	6.4	108	122	115/60/1	1.3	1/7	R-290	-15° to +25°F	2	135
HL-7HC	31 1/2 x 27 3/8 x 32 5/8	7.4	117	130	115/60/1	1.3	1/7	R-290	-15° to +25°F	3	117
HL-11HC	43 1/2 x 27 3/8 x 32 5/8	11.1	143	164	115/60/1	1.4	1/5	R-290	-15° to +25°F	4	90
HL-14HC	51 3/4 x 27 3/8 x 32 5/8	13.8	166	187	115/60/1	2.0	1/4	R-290	-15° to +25°F	5	75
HL-17HC	59 1/2 x 27 3/8 x 32 5/8	16.5	181	201	115/60/1	2.0	1/4	R-290	-15° to +25°F	6	66
HL-20HC	70 5/8 x 27 3/8 x 32 5/8	20.0	213	238	115/60/1	4.1	1/2	R-290	-15° to +25°F	7	56

*Dimensions are all nominal lengths

**Does not include weight of pallets when needed

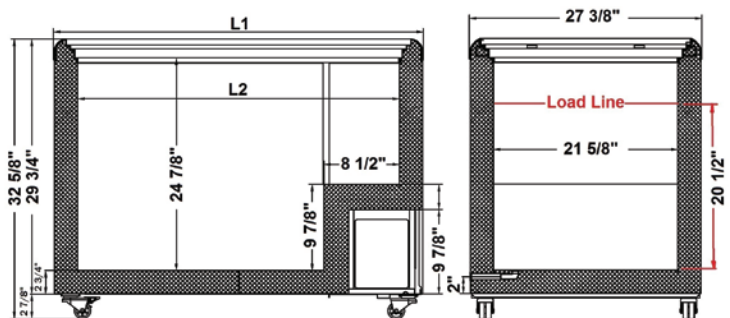

	HL-6LD	HL-7LD	HL-11LD	HL-14LD	HL-17LD	HL-20LD
L1	28 1/4"	31 1/2"	43 1/2"	51 3/4"	59 1/2"	70 5/8"
L2	22 7/8"	25 7/8"	37 7/8"	46 1/8"	53 7/8"	65 1/8"

500 S. Falkenburg Road
 Suite 200 | Tampa, FL 33619
 800.441.4014 | 813.870.0340
www.excellenceindustries.com
 ver. 01.20



HM

Jumbo Freezer and Ice Cream Freezer

500 S. Falkenburg Road
Suite 200 | Tampa, FL 33619
800.441.4014 | 813.870.0340
www.excellenceindustries.com

The company reserves the right to change the design and/or specifications of these products without notice. Printed in the USA.
Current version 01.20

KEY ASPECTS

SPECIAL FEATURES:

- 8 Baskets with 3 dividers each included
- High efficiency compressor
- Casters standard with 2 locking
- Environmentally friendly hydrocarbon refrigerant

OPTIONS:

- False bottoms (special order)
- Graphics
- Partitions (special order)

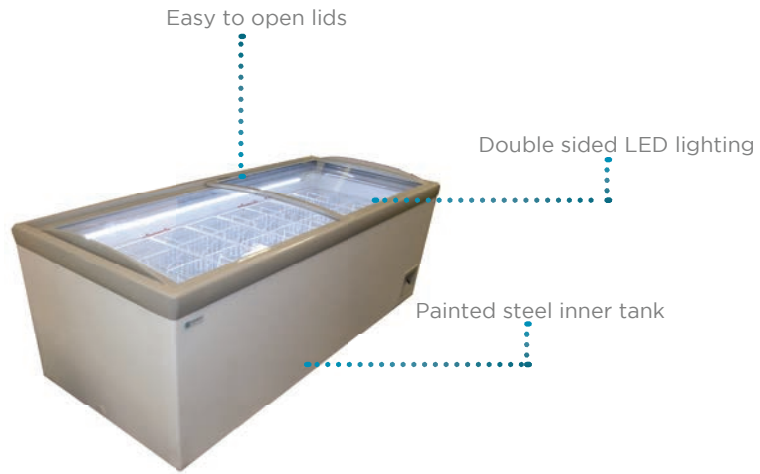

Complies with 2017 DOE standards for commercial freezer and ice cream freezer

TECHNICAL SUMMARY

MODEL	SIZE				ELECTRICAL		REFRIGERATION		OTHER	
	Dimensions (inches)* Width x Depth x Height	Cubic Feet	Net Weight (lbs.)	Shipping Weight (lbs.)**	Voltage/Hz/Phase	Running Amps	Compressor HP	Refrigerant	Temperature	Container Quantity
HM-23HC	73 7/8 x 32 1/2 x 33 1/8	23.3	229	287	115/60/1	5.5	3/4	R-290	-15° to +15°F	39

*Dimensions are all nominal lengths

**Does not include weight of pallets when needed

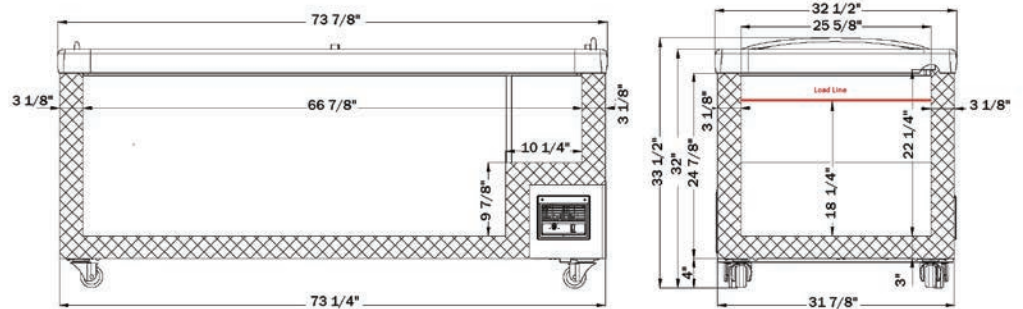

500 S. Falkenburg Road
Suite 200 | Tampa, FL 33619
800.441.4014 | 813.870.0340
www.excellenceindustries.com
ver. 01.20



HR

Island Merchandisers

500 S. Falkenburg Road
Suite 200 | Tampa, FL 33619
800.441.4014 | 813.870.0340
www.excellenceindustries.com

The company reserves the right to change the design and/or specifications of these products without notice. Printed in the USA.
Current version 01.20

KEY ASPECTS

SPECIAL FEATURES:

- Auto defrosting switch
- Plug-in easy installation
- High energy savings
- Environmentally friendly- R-290
- LED lighting
- Operates as cooler, freezer, or ice cream freezer
- Product dividers included

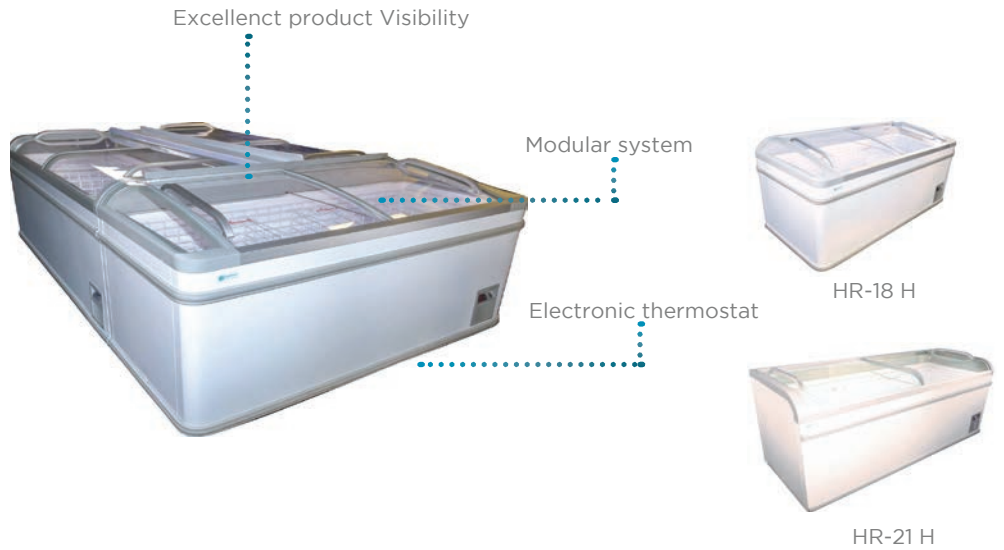

OPTIONS:

- Spacing grill for merging units



Complies with 2017 DOE standards for commercial cooler, freezer and ice cream freezer

TECHNICAL SUMMARY

MODEL	SIZE				ELECTRICAL		REFRIGERATION			OTHER
	Dimensions (inches)* Width x Depth x Height	Cubic Feet	Net Weight (lbs.)	Shipping Weight (lbs.)**	Voltage/Hz/Phase	Running Amps	Compressor HP	Refrigerant	Temperature	Container Quantity
HR-18 H	73 3/8 x 32 1/8 x 34	24.9	254	285	115/60/1	4.1	1/2	R-290	-15°F to 40°F	26
HR-21 H	82 7/8 x 32 1/8 x 34	30.9	304	337	115/60/1	4.1	1/2	R-290	-15°F to 40°F	26

*Dimensions are all nominal lengths

**Does not include weight of pallets when needed



Flexible Location Options

- Can be used as a stand alone unit
- Can be used in a line up
- Maximizes the use of floor space with an end cabinet



500 S. Falkenburg Road
Suite 200 | Tampa, FL 33619
800.441.4014 | 813.870.0340
www.excellenceindustries.com
ver. 01.20



Shown with optional
tub holders

ISL

Solid Lid Ice Cream Freezer

500 S. Falkenburg Road
Suite 200 | Tampa, FL 33619
800.441.4014 | 813.870.0340
www.excellenceindustries.com

The company reserves the right to change the design and/or specifications of these products without notice. Printed in the USA.
Current version 8.19

KEY ASPECTS

SPECIAL FEATURES:

- Perfect for back room storage
- Drain

OPTIONS:

- Graphics
- 3 section hanging baskets
- Can holder kit
- Dipper well

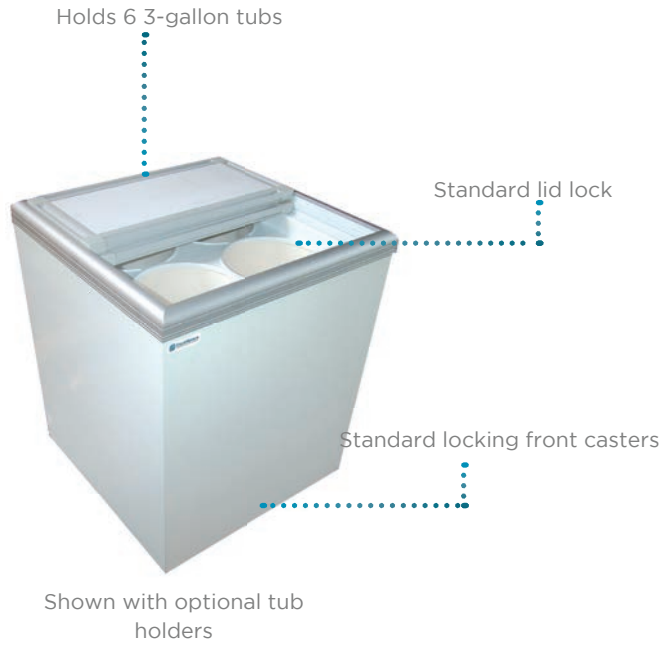

Complies with 2017 DOE standards for commercial ice cream freezer

TECHNICAL SUMMARY

MODEL	SIZE				ELECTRICAL	REFRIGERATION			OTHER			
	Dimensions (inches)* Width x Depth x Height	Cubic Feet	Net Weight (lbs.)	Shipping Weight (lbs.)**	Voltage/Hz/Phase	Running Amps	Compressor HP	Refrigerant	Temperature	3-Gallon Can Capacity	No. of Optional Baskets	Container Quantity
ISL-5	24 1/2 x 24 1/2 x 36	6.0	86	104	115/60/1	2.8	1/5	R-134a	-15° to +5°F	6	2	138

*Dimensions are all nominal lengths

**Does not include weight of pallets when needed

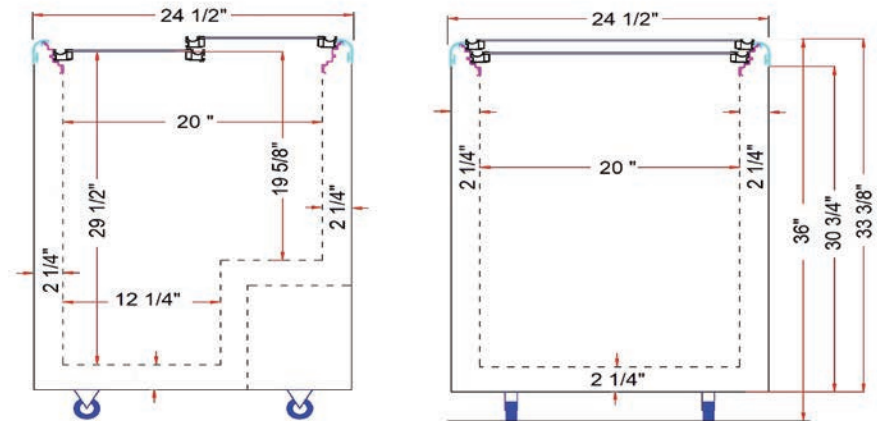

500 S. Falkenburg Road
Suite 200 | Tampa, FL 33619
800.441.4014 | 813.870.0340
www.excellenceindustries.com
ver 8.19



MB

Dual Temperature Mini Bunker Cooler and Freezer

500 S. Falkenburg Road
Suite 200 | Tampa, FL 33619
800.441.4014 | 813.870.0340
www.excellenceindustries.com

The company reserves the right to change the design and/or specifications of these products without notice. Printed in the USA.
Current version 06.20

KEY ASPECTS

SPECIAL FEATURES:

- Painted steel interior
- Cold wall evaporator
- Baskets include 2 dividers each
- Casters standard, front locking
- Environmentally friendly hydrocarbon refrigerant

OPTIONS:

- LED light bar
- Lock & key
- Graphics

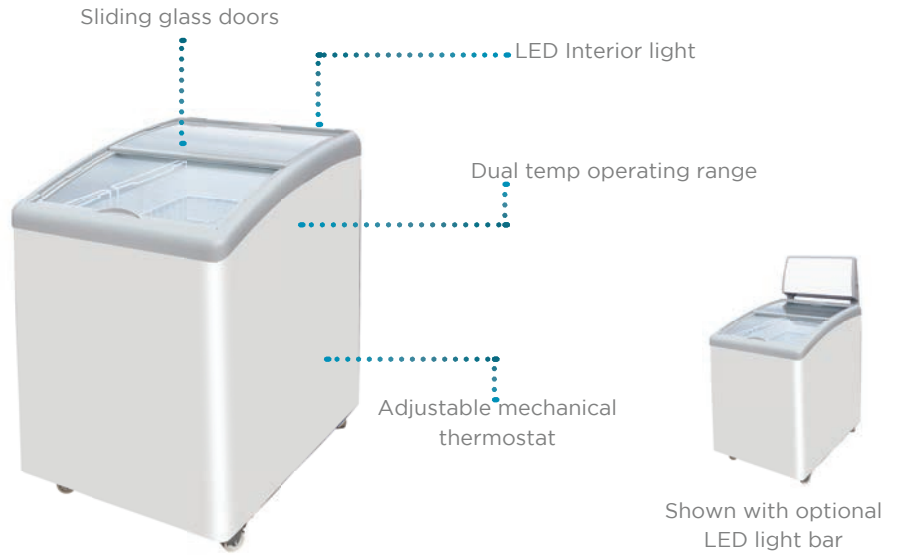

Complies with 2017 DOE standards for commercial cooler and freezer

TECHNICAL SUMMARY

MODEL	SIZE	ELECTRICAL			REFRIGERATION			OTHER			
	Dimensions (inches)* Width x Depth x Height	Cubic Feet	Net Weight (lbs.)	Shipping Weight (lbs.)**	Voltage/Hz/Phase	Running Amps	Compressor HP	Refrigerant	Temperature	Number of baskets	Container Quantity
MB-2HCD	23 x 27 3/8 x 33 1/2	4.8	106	119	115/60/1	1.0	1/9	R-600a	-5°F to +40°F	2	168

*Dimensions are all nominal lengths

**Does not include weight of pallet when needed

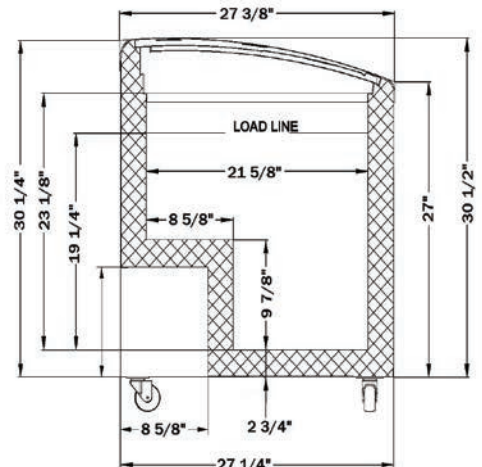
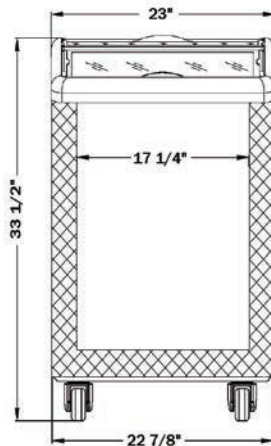

Optional light bar adds 11 3/8"



500 S. Falkenburg Road
Suite 200 | Tampa, FL 33619
800.441.4014 | 813.870.0340
www.excellenceindustries.com
ver. 06.20



MC

Curved Mini Bunker Freezer and Ice Cream Freezer

500 S. Falkenburg Road
Suite 200 | Tampa, FL 33619
800.441.4014 | 813.870.0340
www.excellenceindustries.com

The company reserves the right to change the design and/or specifications of these products without notice. Printed in the USA.
Current version 01.20

KEY ASPECTS

SPECIAL FEATURES:

- Painted steel interior
- Cold wall evaporator
- Baskets include 2 dividers each
- Casters standard, 2 front locking
- Environmentally friendly hydrocarbon refrigerant

OPTIONS:

- LED light bar
- Lock & key
- Graphics



Complies with 2017 DOE standards for commercial freezer and ice cream freezer

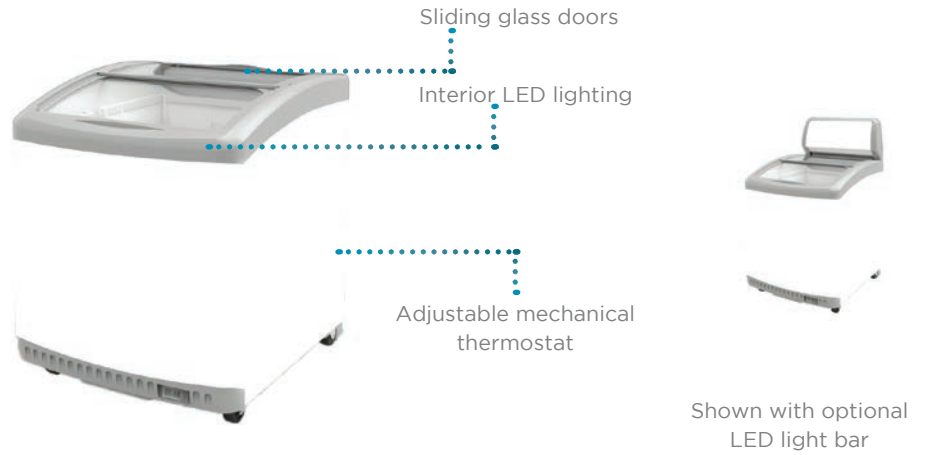

TECHNICAL SUMMARY

MODEL	SIZE	ELECTRICAL			REFRIGERATION			OTHER			
	Dimensions (inches)* Length x Depth x Height	Cubic Feet	Net Weight (lbs.)	Shipping Weight (lbs.)**	Voltage/Hz/Phase	Running Amps	Compressor HP	Refrigerant	Temperature	Number of baskets	Container Quantity
MC-2HC	24 5/8 x 27 3/4 x 33 1/2	4.8	106	119	115/60/1	1.0	1/9	R-600a	-15° to +20°F	2	159

*Dimensions are all nominal lengths

**Does not include weight of pallet when needed

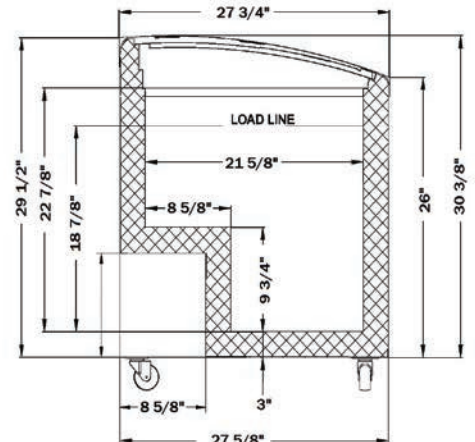
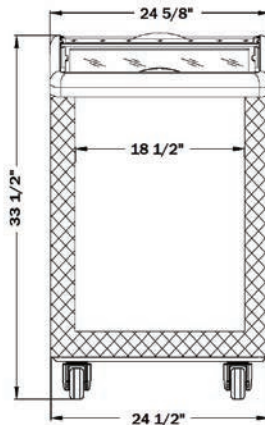

Optional light bar adds 10 1/2" height and 1 1/4" depth



500 S. Falkenburg Road
Suite 200 | Tampa, FL 33619
800.441.4014 | 813.870.0340
www.excellenceindustries.com
ver. 01.20



MCSC

Milk Cooler

KEY ASPECTS

SPECIAL FEATURES:

- Reinforced interior base
- Floor racks
- Heavy duty fan motor
- Cold wall evaporator
- One screw quick access for maintenance

OPTIONS:

- Graphics

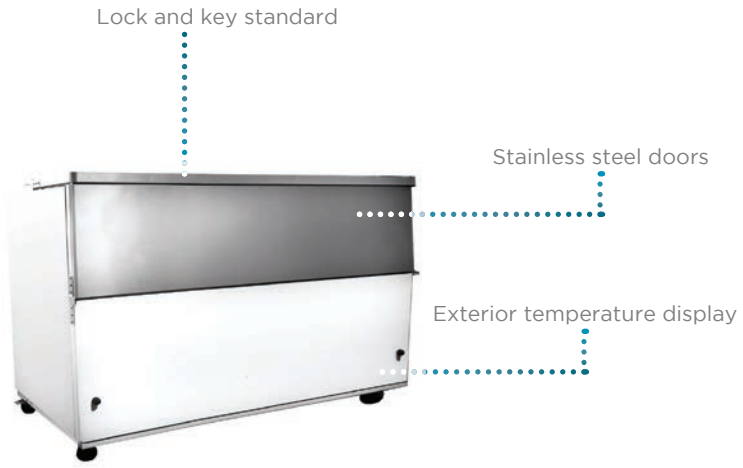

Complies with 2017 DOE standards for commercial cooler with solid doors

TECHNICAL SUMMARY

MODEL	SIZE				ELECTRICAL	REFRIGERATION			OTHER		
	Dimensions (inches)* Width x Depth x Height	Cubic Feet	Net Weight (lbs.)	Shipping Weight (lbs.)**	Voltage/Hz/Phase	Running Amps	Compressor HP	Refrigerant	Temperature	No. of Milk Crates	Container Quantity
MCSC-12	44 5/8 x 32 3/4 x 41 3/4	41	254	318	115/60/1	6	3/8	R-134a	+32°F to +38°F	12	46
MCSC-16	59 1/8 x 32 3/4 x 41 3/4	53	299	385	115/60/1	6	3/8	R-134a	+32°F to +38°F	16	42

*Dimensions are all nominal lengths

**Does not include weight of pallets when needed

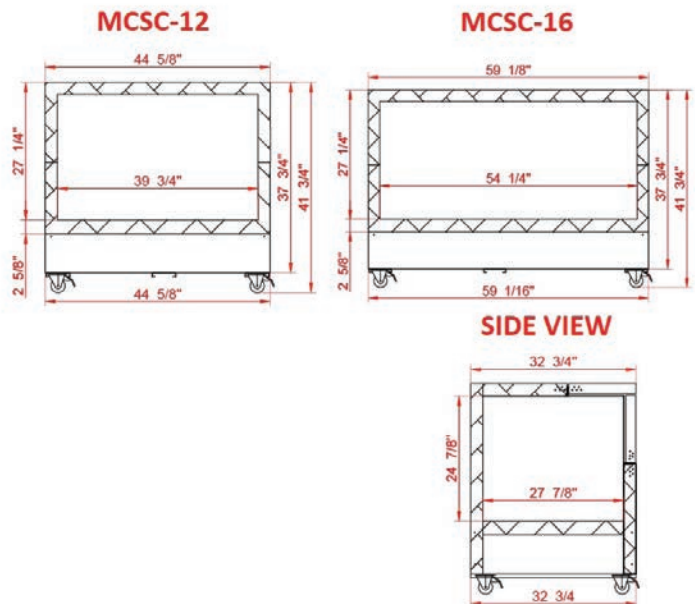

500 S. Falkenburg Road
 Suite 200 | Tampa, FL 33619
 800.441.4014 | 813.870.0340
www.excellenceindustries.com
 ver. 8.19



MCT

Freezer and Ice Cream Freezer with Merchandising Platform

500 S. Falkenburg Road
Suite 200 | Tampa, FL 33619
800.441.4014 | 813.870.0340
www.excellenceindustries.com

The company reserves the right to change the design and/or specifications of these products without notice. Printed in the USA.
Current version 9.19

KEY ASPECTS

SPECIAL FEATURES:

- Glass front (MCT-4 & 6)
- Top shelf for dry goods and merchandising
- Drain
- Adjustable legs on MCT-4 & 6
- Casters with 2 locking on MCT-2
- Environmentally friendly

OPTIONS:

- Graphics
- Casters



Complies with 2017 DOE standards for commercial freezer and ice cream freezer

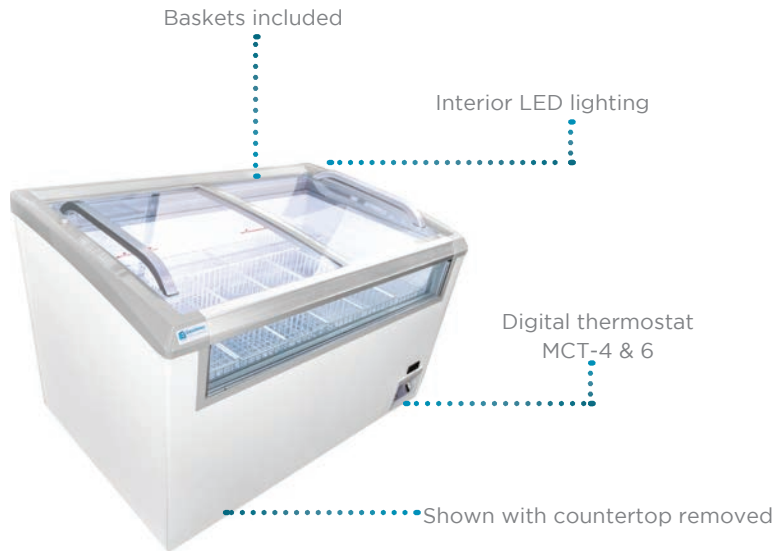

Double Combo-MCT-4HC with 2 optional CTF-3HC



Combo MCT-2HC with 1 optional CTF-3HC

TECHNICAL SUMMARY

MODEL	SIZE Dimensions (inches)* Width x Depth x Height***	ELECTRICAL			REFRIGERATION			OTHER				
		Cubic Feet	Net Weight (lbs.)	Shipping Weight (lbs.)**	Voltage/Hz/Phase	Running Amps	Compressor HP	Refrigerant	Temperature	No. of standard baskets	No. of facings	Container Quantity
MCT-2	25 x 35 1/2 x 41 1/2	5.8	110	121	115/60/1	1.0	1/5	R-600a	-15° to +15°F	2	4	108
MCT-4HC	49 3/8 x 35 1/2 x 41 1/2	13.2	213	264	115/60/1	2.0	1/4	R-290	-15° to +15°F	5	20	42
MCT-6	73 3/8 x 35 1/2 x 41 1/2	21.2	296	356	115/60/1	4.1	3/4	R-290	-15° to +15°F	8	32	26

*Dimensions are all nominal lengths

**Does not include weight of pallet when needed

***Add 2" for optional casters

***Reduce 8" if counter is removed



500 S. Falkenburg Road
Suite 200 | Tampa, FL 33619
800.441.4014 | 813.870.0340
www.excellenceindustries.com
ver. 9.19

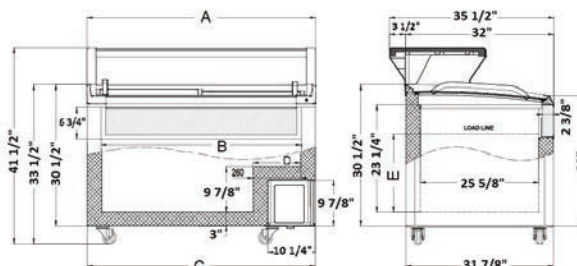

All Dimensions in inches

	A	B	C	D	E
MCT-2HC	25	18 1/2	24 3/4	18 1/2	19 3/8
MCT-4	49 3/8	42 7/8	49 1/4	10 1/4	17
MCT-5	59 1/2	53	59 1/4	10 1/4	17
MCT-6	73 3/8	67	73 1/4	10 1/4	17

MCT-2 does not have the front glass shown on the drawing above



115 Volt!

PGC

Gelato Dipping Cabinet

500 S. Falkenburg Road
Suite 200 | Tampa, FL 33619
800.441.4014 | 813.870.0340
www.excellenceindustries.com

The company reserves the right to change the design and/or specifications of these products without notice. Printed in the USA.
Current version 05.20

KEY ASPECTS

SPECIAL FEATURES:

- Self defrosting
- Rear pivoting door
- Electronic control board
- Refrigerated storage compartment
- Modern design ideal for impulse sales

OPTIONS:

- Graphics
- Dipperwell

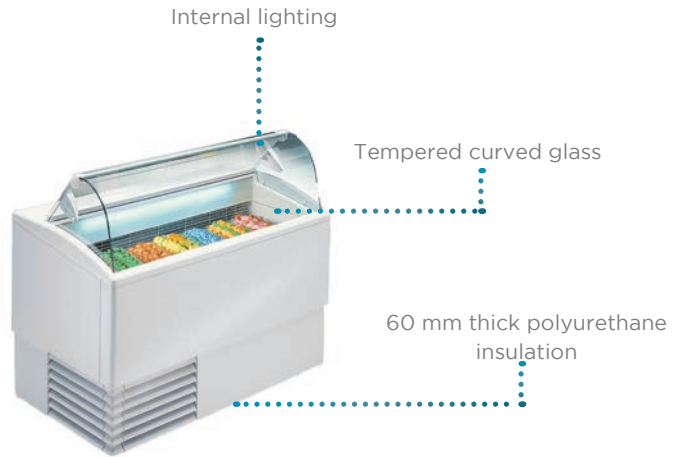

Additional storage compartment



Understorage



Complies with 2017 DOE standards for commercial freezer service over counter

TECHNICAL SUMMARY

MODEL	SIZE Width x Depth x Height	ELECTRICAL		REFRIGERATION			OTHER					
		Net Weight (lbs.)	Shipping Weight (lbs.)**	Voltage/Hz/Phase	Running Amps	Compressor HP	Refrigerant	Temperature	Defrosting	5 L Pans Displayed	5 L Pans Stored	Container Quantity
PGC-6	47 x 31 1/2 x 46	214	276	115/60/1	9.2	1	R-404a	-3° to +10°F	Auto	6	14	44
PGC-7	53 1/2 x 31 1/2 x 46	225	289	115/60/1	8.2	1	R-404a	-3° to +10°F	Auto	7	19	32

*Dimensions are all nominal lengths

**Does not include weight of pallet when needed

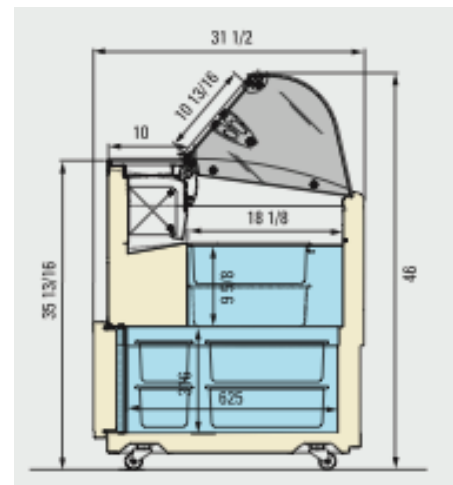

500 S. Falkenburg Road
Suite 200 | Tampa, FL 33619
800.441.4014 | 813.870.0340
www.excellenceindustries.com
ver. 05.20



RF

Barrel Freezer & Ice Cream Freezer

500 S. Falkenburg Road
Suite 200 | Tampa, FL 33619
800.441.4014 | 813.870.0340
www.excellenceindustries.com

The company reserves the right to change the design and/or specifications of these products without notice. Printed in the USA.
Current version 8.19

KEY ASPECTS

SPECIAL FEATURES:

- Big impression in a small footprint
- Adjustable thermostat
- Casters standard
- Environmentally friendly hydrocarbon refrigerant

OPTIONS:

- Graphics



Complies with 2017 DOE standards for commercial freezer and ice cream freezer

Flip top accessible from any side



Divider: 4 sections



4 section divider top view

Cylinder shaped, looks great anywhere



With optional graphics

TECHNICAL SUMMARY

MODEL	SIZE				ELECTRICAL		REFRIGERATION		OTHER	
	Dimensions (inches)* Width x Depth x Height	Cubic Feet	Net Weight (lbs.)	Shipping Weight (lbs.)**	Voltage/Hz/Phase	Running Amps	Compressor HP	Refrigerant	Temperature	Container Quantity
RF-77HC	22 1/4 x 22 1/4 x 32 5/8	2.5	64	73	115/60/1	2.1	2/7	R-600a	-15°F to +5°F	238

*Dimensions are all nominal lengths

**Does not include weight of pallets when needed

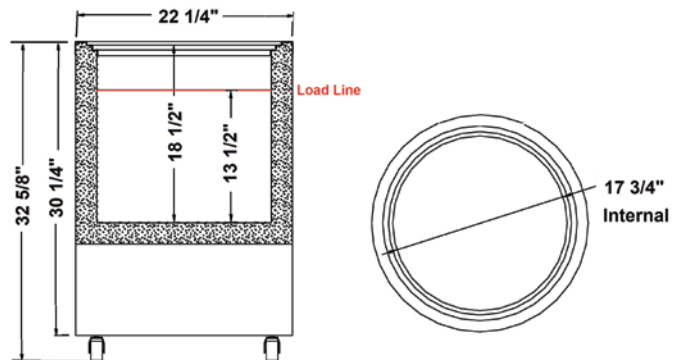

500 S. Falkenburg Road
Suite 200 | Tampa, FL 33619
800.441.4014 | 813.870.0340
www.excellenceindustries.com
ver. 8.19



SC

Countertop Cooler

500 S. Falkenburg Road
Suite 200 | Tampa, FL 33619
800.441.4014 | 813.870.0340
www.excellenceindustries.com

The company reserves the right to change the design and/or specifications of these products without notice. Printed in the USA.
Current version 8.19

KEY ASPECTS

SPECIAL FEATURES:

- Standard door lock
- Recessed door handle

OPTIONS:

- Graphics



TECHNICAL SUMMARY

MODEL	SIZE				ELECTRICAL		REFRIGERATION			OTHER	
	Dimensions (inches)* Length x Depth x Height	Cubic Feet	Net Weight (lbs.)	Shipping Weight (lbs.)**	Voltage/Hz/Phase	Running Amps	Compressor HP	Refrigerant	Temperature	Number of shelves	Container Quantity
SC-22	13 x 16 1/4 x 24	0.7	50	53	115/60/1	0.72	1/10	R-134a	+32°F to +41°F	2	620

*Dimensions are all nominal lengths

**Does not include weight of pallet when needed



500 S. Falkenburg Road
 Suite 200 | Tampa, FL 33619
 800.441.4014 | 813.870.0340
 www.excellenceindustries.com
 ver. 8.19

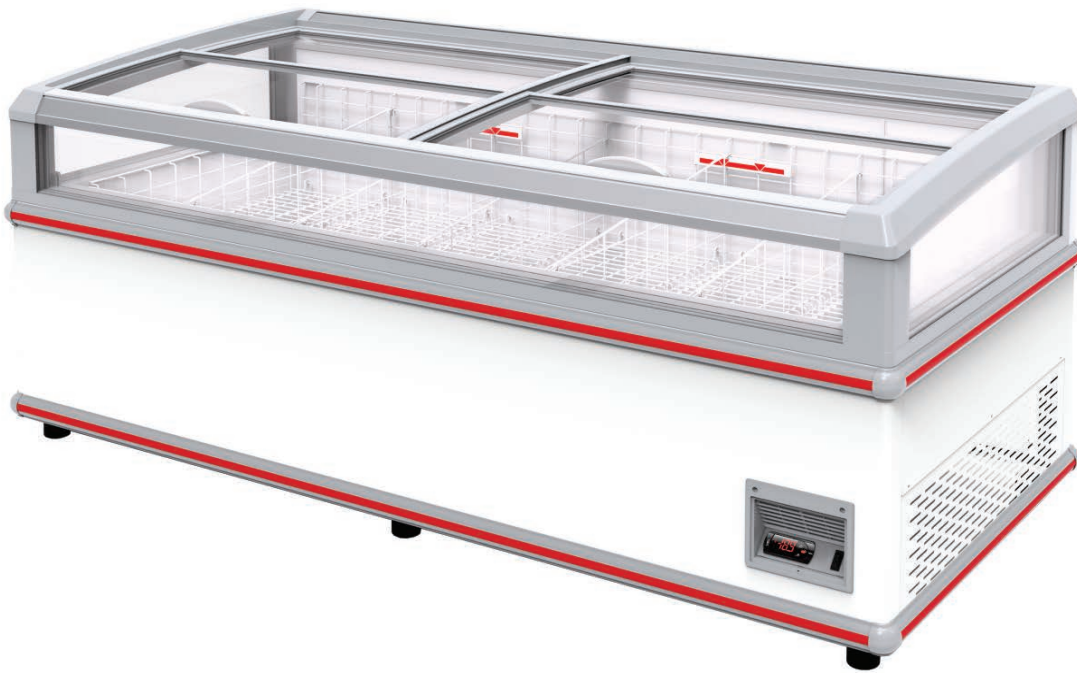

SM

Deluxe Ice Cream Freezer

500 S. Falkenburg Road
Suite 200 | Tampa, FL 33619
800.441.4014 | 813.870.0340
www.excellenceindustries.com

The company reserves the right to change the design and/or specifications of these products without notice. Printed in the USA.
Current version 01.20

KEY ASPECTS

SPECIAL FEATURES:

- Baskets with product dividers standard
- Adjustable thermostat
- Painted steel interior
- LED lighted interior

OPTIONS:

- Graphics
- Lock and key
- Wire racks with dividers

Three sided glass

Excellent product visibility

Convenient pull lids



Complies with 2017 DOE standards for commercial ice cream freezer

TECHNICAL SUMMARY

MODEL	SIZE				ELECTRICAL	REFRIGERATION			OTHER		
	Dimensions (inches)* Width x Depth x Height	Cubic Feet	Net Weight (lbs.)	Shipping Weight (lbs.)**	Voltage/Hz/Phase	Running Amps	Compressor HP	Refrigerant	Temperature	No. of Baskets	Container Quantity
SM-6	73 1/2 x 32 x 32 1/2	15.2	265	314	115/60/1	4.1	1/2	R-290	-15°F to +5°F	8	26

*Dimensions are all nominal lengths

**Does not include weight of pallets when needed

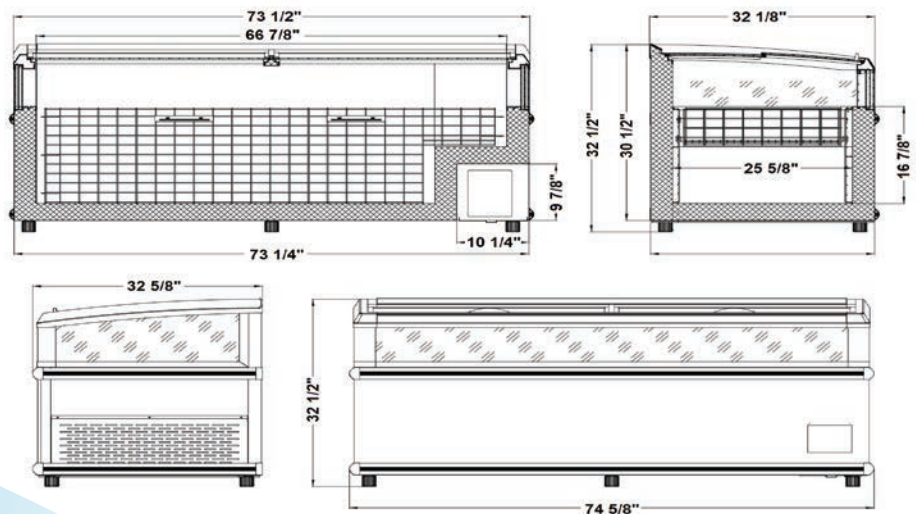

500 S. Falkenburg Road
Suite 200 | Tampa, FL 33619
800.441.4014 | 813.870.0340
www.excellenceindustries.com
ver 01.20



SPOT

Dual Temperature Merchandiser

500 S. Falkenburg Road
Suite 200 | Tampa, FL 33619
800.441.4014 | 813.870.0340
www.excellenceindustries.com

The company reserves the right to change the design and/or specifications of these products without notice. Printed in the USA.
Current version 01.20

KEY ASPECTS

SPECIAL FEATURES:

- Standard with wire shelf
- Adjustable thermostat
- Painted steel interior
- Casters with 2 locking
- Operates as a cooler or freezer

OPTIONS:

- Graphics

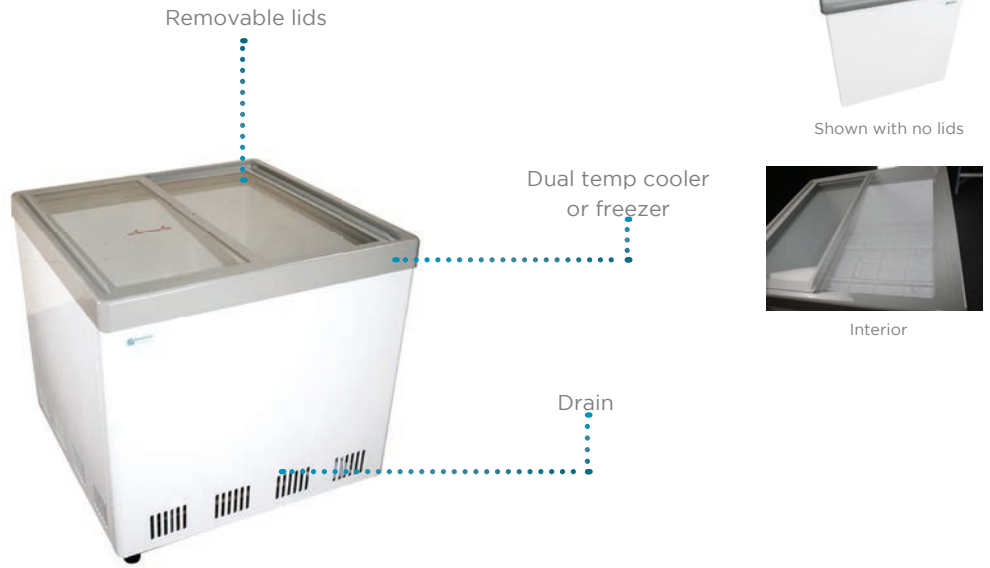

Complies with 2017 DOE standards for commercial cooler and freezer with or without doors

TECHNICAL SUMMARY

MODEL	SIZE Dimensions (inches)* Width x Depth x Height	ELECTRICAL			REFRIGERATION			OTHER			
		Cubic Feet	Net Weight (lbs.)	Shipping Weight (lbs.)**	Voltage/Hz/Phase	Running Amps	Compressor HP	Refrigerant	Temperature	No. of 12" Facings	Container Quantity
SPOT-4HCD	35 5/8 x 35 5/8 x 34 1/8	8.3	159	172	115/60/1	1.4	1/3	R-290	0°F to +40°F	4	48
SPOT-6HCD	47 3/8 x 35 5/8 x 34 1/8	11.5	172	192	115/60/1	2.0	1/3	R-290	0°F to +40°F	6	42

*Dimensions are all nominal lengths

**Does not include weight of pallets when needed

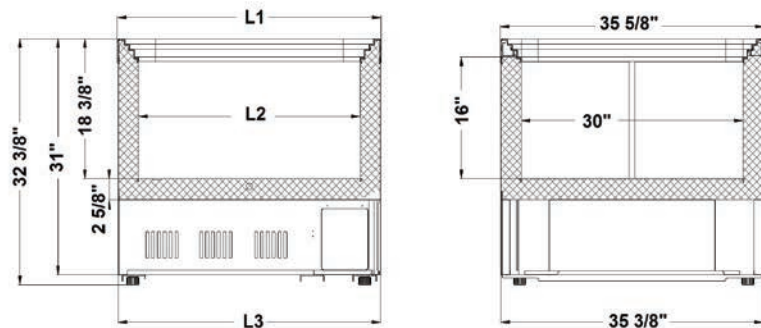

MODEL	L1	L2	L3
Spot 4	35 5/8"	30"	35 1/2"
Spot 6	47 3/8"	41 3/4"	47 1/4"



500 S. Falkenburg Road
Suite 200 | Tampa, FL 33619
800.441.4014 | 813.870.0340
www.excellenceindustries.com
ver. 01.20



UCS

Ultra Cold Storage Freezer

500 S. Falkenburg Road
Suite 200 | Tampa, FL 33619
800.441.4014 | 813.870.0340
www.excellenceindustries.com

The company reserves the right to change the design and/or specifications of these products without notice. Printed in the USA.
Current version 8.19

KEY ASPECTS

SPECIAL FEATURES:

- Adjustable electronic thermostat
- Can be attached to external alarm
- Acoustic alarm
- Environmentally friendly hydrocarbon refrigerant

OPTIONS:

- Graphics

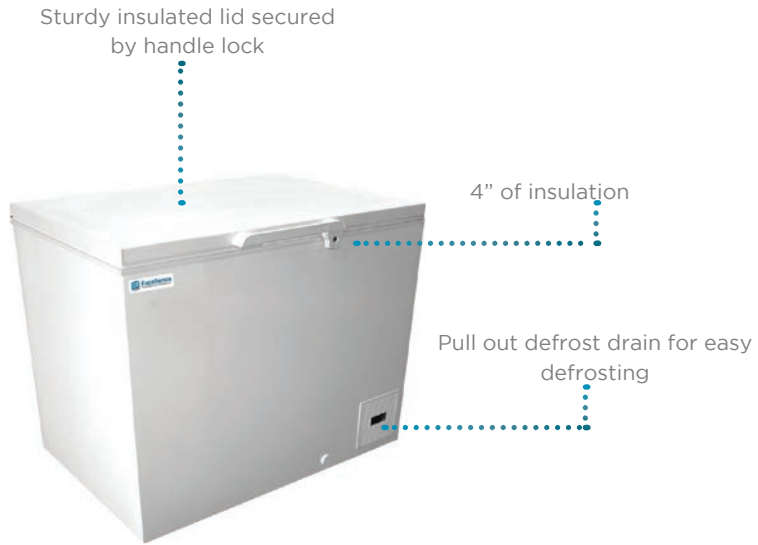

TECHNICAL SUMMARY

MODEL	SIZE				ELECTRICAL		REFRIGERATION			OTHER
	Dimensions (inches)* Width x Depth x Height	Cubic Feet	Net Weight (lbs.)	Shipping Weight (lbs.)**	Voltage/Hz/Phase	Running Amps	Compressor HP	Refrigerant	Temperature	Container Quantity
UCS-28HC	28 1/2 x 25 3/4 x 34	5.0	101	108	115/60/1	2.0	1/2	R-290	-50°F to +15°F	126
UCS-41HC	41 1/2 x 25 3/4 x 34	8.6	130	137	115/60/1	3.1	3/4	R-290	-50°F to +15°F	88

*Dimensions are all nominal lengths

**Does not include weight of pallets when needed



500 S. Falkenburg Road
 Suite 200 | Tampa, FL 33619
 800.441.4014 | 813.870.0340
www.excellenceindustries.com
 ver. 8.19

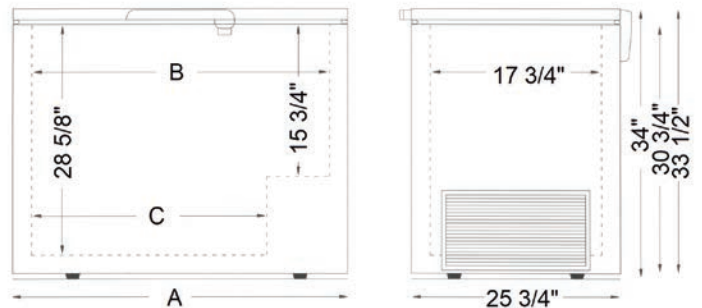

	UCS-28	UCS-41
A	28 1/2"	41 1/2"
B	20 1/2"	33 1/2"
C	12 5/8"	25 5/8"



VB

Curved Lid Display Freezer And Ice Cream Freezer

500 S. Falkenburg Road
Suite 200 | Tampa, FL 33619
800.441.4014 | 813.870.0340
www.excellenceindustries.com

The company reserves the right to change the design and/or specifications of these products without notice. Printed in the USA.
Current version 01.20

KEY ASPECTS

SPECIAL FEATURES:

- Baskets with product dividers included
- Adjustable thermostat
- Painted steel interior
- LED lighted interior

OPTIONS:

- Graphics
- Lock and key
- Built in analog thermometer- full container orders only

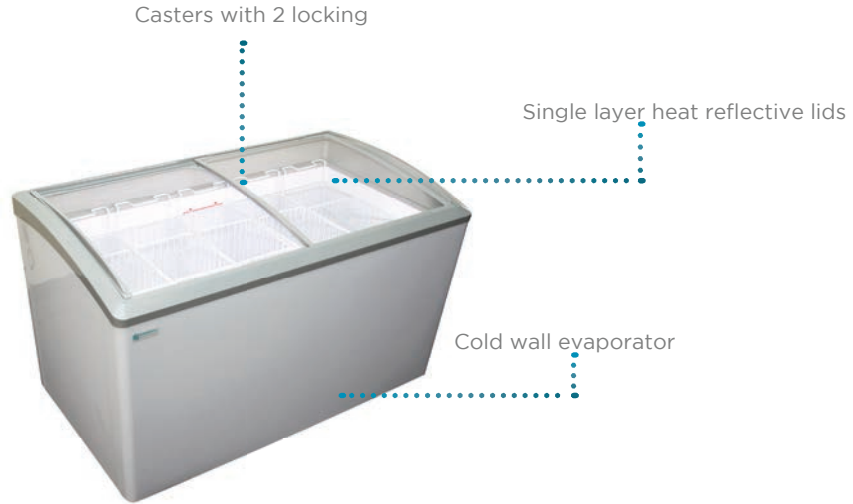

Complies with 2017 DOE standards for commercial freezer and commercial ice cream freezer

TECHNICAL SUMMARY

MODEL	SIZE				ELECTRICAL		REFRIGERATION			OTHER	
	Dimensions (inches)* Width x Depth x Height	Cubic Feet	Net Weight (lbs.)	Shipping Weight (lbs.)**	Voltage/Hz/Phase	Running Amps	Compressor HP	Refrigerant	Temperature	No. of Baskets	Container Quantity
VB-2HC	28 1/2 x 27 3/8 x 33 1/2	6.3	112	128	115/60/1	1.3	1/7	R-290	-15°F to +15°F	2	126
VB-3HC	31 1/2 x 27 3/8 x 33 1/2	7.3	117	133	115/60/1	1.3	1/7	R-290	-15°F to +15°F	3	117
VB-4HC	41 1/8 x 27 3/8 x 33 1/2	10.4	146	159	115/60/1	1.4	1/5	R-290	-15°F to +15°F	4	94
VB-5HC	48 7/8 x 27 3/8 x 33 1/2	12.9	166	181	115/60/1	2.0	1/4	R-290	-15°F to +15°F	5	80
VB-6HC	59 1/2 x 27 3/8 x 33 1/2	16.3	188	202	115/60/1	2.0	1/4	R-290	-15°F to +15°F	6	66
VB-7HC	66 3/8 x 27 3/8 x 33 1/2	18.5	202	222	115/60/1	3.0	1/5	R-290	-15°F to +15°F	7	57

*Dimensions are all nominal lengths

**Does not include weight of pallets when needed

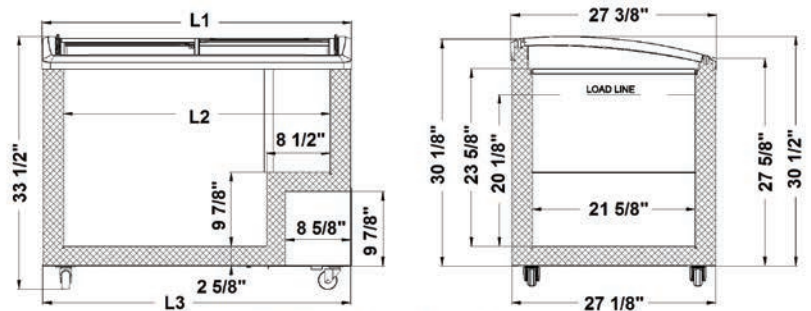

MODEL	L1	L2	L3
VB-2	28 1/2"	22 7/8"	28 3/8"
VB-3	31 1/2"	25 7/8"	31 3/8"
VB-4	41 1/8"	35 1/2"	41"
VB-5	48 7/8"	41 1/8"	48 5/8"
VB-6	59 1/2"	53 3/4"	59 1/4"
VB-7	66 3/8"	60 5/8"	66 1/8"

500 S. Falkenburg Road
 Suite 200 | Tampa, FL 33619
 800.441.4014 | 813.870.0340
www.excellenceindustries.com
 ver. 01.20



VBN

Narrow Bunker

KEY ASPECTS

SPECIAL FEATURES:

- Small footprint
- Baskets with product dividers standard
- Adjustable thermostat
- Painted steel interior
- LED lighted interior

OPTIONS:

- Graphics
- Lock and key

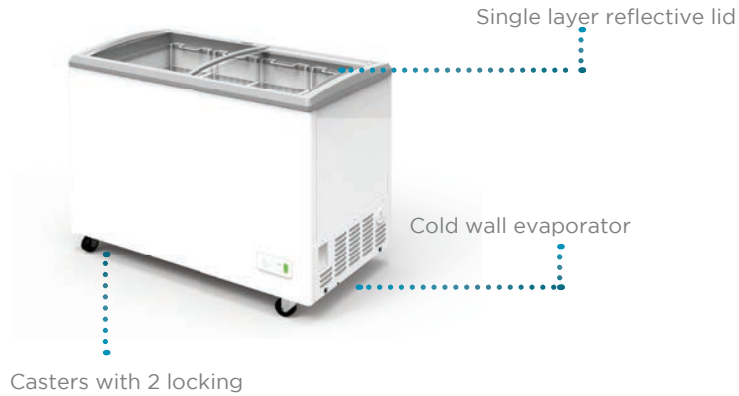

Complies with 2017 DOE standards for cooler, freezer and ice cream freezer

TECHNICAL SUMMARY

MODEL	SIZE				ELECTRICAL		REFRIGERATION			OTHER	
	Dimensions (inches)* Width x Depth x Height	Cubic Feet	Net Weight (lbs.)	Shipping Weight (lbs.)**	Voltage/Hz/Phase	Running Amps	Compressor HP	Refrigerant	Temperature	No. of Baskets	Container Quantity
VBN-4	38 1/2 x 21 3/4 x 33	5.8	109	120	115/60/1	1.3	1/7	R-600	-15°F to +40°F	4	123

*Dimensions are all nominal lengths

**Does not include weight of pallets when needed

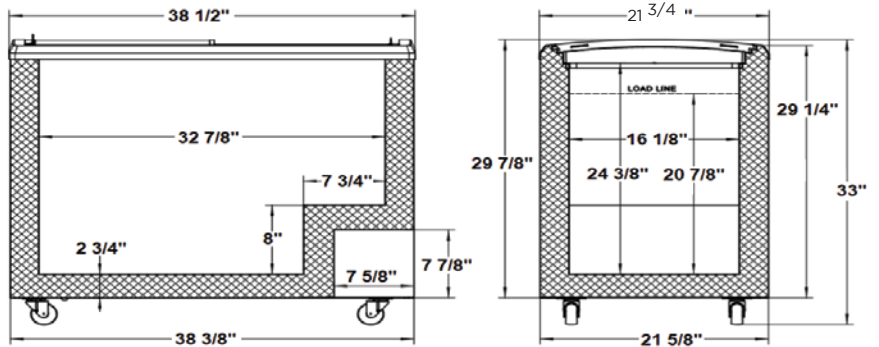

500 S. Falkenburg Road
 Suite 200 | Tampa, FL 33619
 800.441.4014 | 813.870.0340
www.excellenceindustries.com
 ver 01.20

Excellence Commercial Products

STANDARD WARRANTY - Within the Continental United States

Excellence Industries warrants to the user:

ONE YEAR CABINET WARRANTY

The cabinet and all of its parts shall be free of defects in the material and workmanship under normal use and service for a period of one year from the date of purchase. Excellence Industries sole obligation under this warranty shall be limited, at its option, to either repairing or replacing any part of the cabinet determined by Excellence Industries to be defective. Excellence will pay standard labor rates when service is dispatched through Excellence Industries national service desk at 1-877-872-3797. Labor for outside service companies is only reimbursable with prior arrangements and written approval from Excellence Industries.

ADDITIONAL FOUR-YEAR COMPRESSOR WARRANTY

In addition to the Standard Warranty, Excellence Industries offers an additional FOUR YEAR COMPRESSOR WARRANTY. Excellence Industries agrees to replace the compressor with a compressor of like or one or similar design an capacity if it is determined by Excellence that the compressor is inoperative due to defects in factory workmanship or material under normal use and service. The warranty is for the part only and does not include any labor charges.

Excellence's obligation under the Four-Year Compressor Warranty Contract shall be limited to a period not to exceed five years from the date of installation. The Four-Year Compressor Warranty does not apply to any part of the cabinet or its finish, nor does it apply to the control, relay, fan or any electrical component.

Further terms of the contract cannot be considered valid if the compressor has been subjected to an accident, alteration, abuse, misuse, or damaged by shipping, delivery, flood, fire, or acts of God. The Four-Year Compressor Warranty Contract shall place no liability on Excellence for any labor or labor costs in replacing the compressor, heat exchanger, drier, fan or replaceable parts of the cabinet. Excellence Industries shall only be obligated to furnish the replacement compressor.

LIMITED FIVE YEAR LEAK WARRANTY

The cabinet shall be free of insulation failures and refrigerant leaks within the insulated area of the cabinet for a period of five years from the date of installation or six years from the date of manufacture, whichever occurs first. Excellence sole obligation under this warranty shall be limited to the following:

- Year one after purchase – Full replacement including freight.
- Year two after purchase – A new cabinet can be purchased by customer at 20% of the original purchase price. Customer to bear cost of freight from Excellence warehouse.
- Year three after purchase – A new cabinet can be purchased by customer at 40% of the original purchase price. Customer to bear cost of freight from Excellence warehouse.
- Year four after purchase – A new cabinet can be purchased by customer at 60% of the original purchase price. Customer to bear cost of freight from Excellence warehouse.
- Year five after purchase – A new cabinet can be purchased by customer at 80% of the original purchase price. Customer to bear cost of freight from Excellence warehouse.

At Excellence Industries discretion, the company can demand return of the cabinet in question. Excellence will pay any associated cost of freight to perform internal leak tests. If the unit is deemed to not have an internal leak, the customer must bear all the cost of freight both to and from Excellence's facilities and service.

Do not Drill Holes in Cabinet

Refrigeration tubing and wiring is routed through the cabinet walls. Leaks, wet insulation, or electrical problems caused by drilled holes are not covered by warranty. Any tampering with, drilling holes in or unauthorized modification to the cabinet will void all warranties.

General:

ABUSE, MISUSE, ACCIDENTS – Excellence Industries shall not be responsible for parts or assemblies, which upon inspection are determined by Excellence Industries to have been subjected to misuse, neglect, lack of maintenance, alteration, accident, abuse, damage during transit or delivery or by fire or flood.

CONSEQUENTIAL DAMAGES - IN NO EVENT SHALL EXCELLENCE INDUSTRIES BE LIABLE FOR SPECIAL, INDIRECT OR CONSEQUENTIAL DAMAGES, INCLUDING WITHOUT LIMITATION, FOOD SPOILAGE OR PRODUCT SPOILAGE CLAIMS, NOR FOR ANY DELAY IN THE PERFORMANCE OF THIS WARRANTY DUE TO CAUSES BEYOND ITS CONTROL.

The standard warranty and any service contract related to the STANDARD WARRANTY shall apply only to the products sold and used within the boundaries of the Continental United States.

Users may file warranty claims either directly with Stajac or with immediate seller from whom the cabinet was purchased. All claims must be supported by information concerning the alleged defect and specifically identified by the Serial Number of the cabinet.

THERE ARE NO OTHER WARRANTIES EXPRESS, IMPLIED OR STATUTORY, EXCEPT THIS WARRANTY, WHICH IS IN LIEU OF ALL OTHER WARRANTIES INCLUDING TO THE EXTENT PERMITTED BY LAW, ANY IMPLIED WARRANTY OF MERCHANTABILITY OR FITNESS FOR A PARTICULAR PURPOSE.

EXCELLENCE INDUSTRIES

500 S. Falkenburg Road, Suite 200 • Tampa, Florida 33619
813-870-0340

Effective January 1, 2017

Exceptional Global Experience
Extra-Mile Customer Service
Extraordinary Refrigeration Solutions



Profit from the Power of Partnership.

500 S. Falkenburg Road
Suite 200 | Tampa, FL 33619
800.441.4014 | 813.870.0340
www.excellenceindustries.com